

Tivoli™

Tivoli by Architectural Railings & Grilles
(704) 365-5152

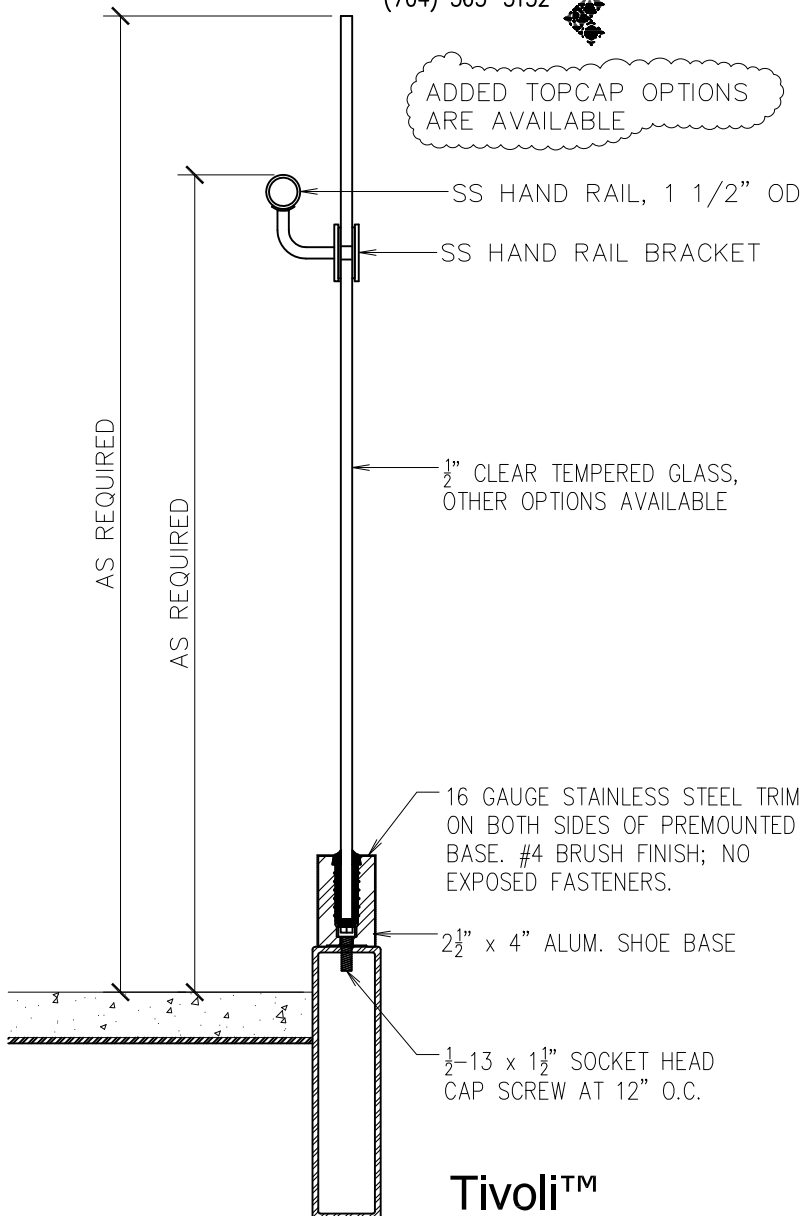

ADDED TOPCAP OPTIONS
ARE AVAILABLE



RAIL DESIGN: Tivoli



**Architectural
Railings & Grilles**
Fort Mill, SC
(704)-365-5152

Please visit our
website for
available options
and materials.
www.stainless-railing.com

Tivoli™

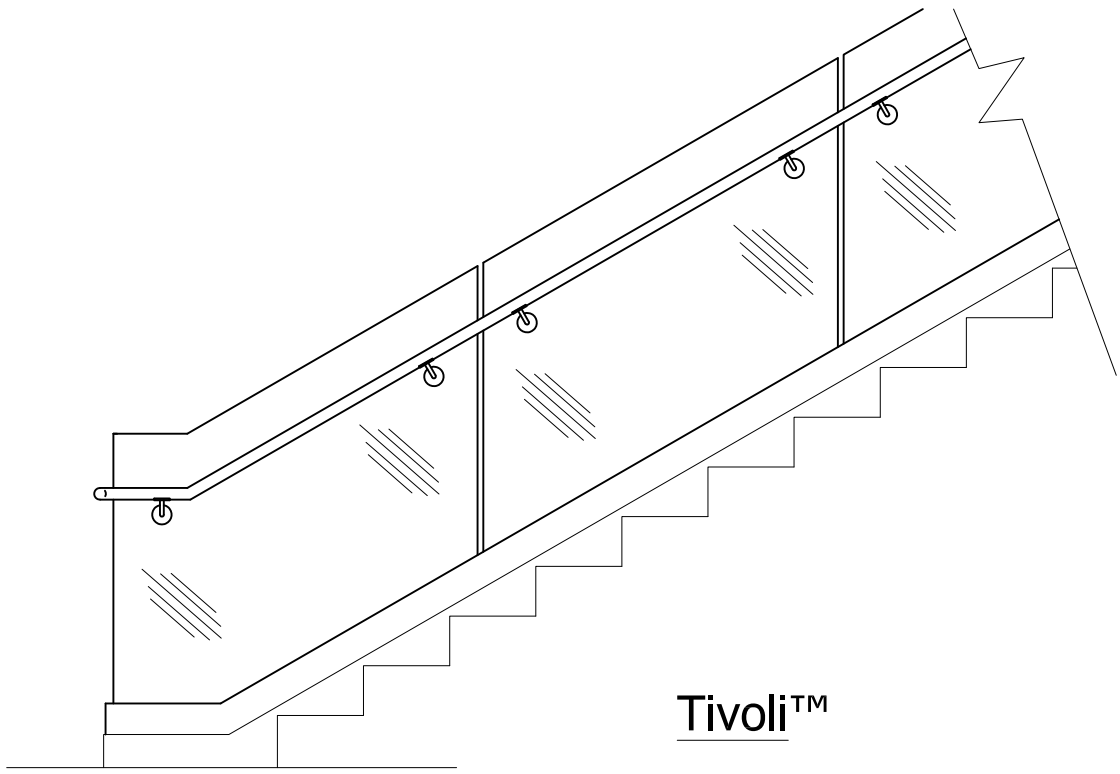

Tivoli™

Tivoli by Architectural Railings & Grilles
(704) 365-5152

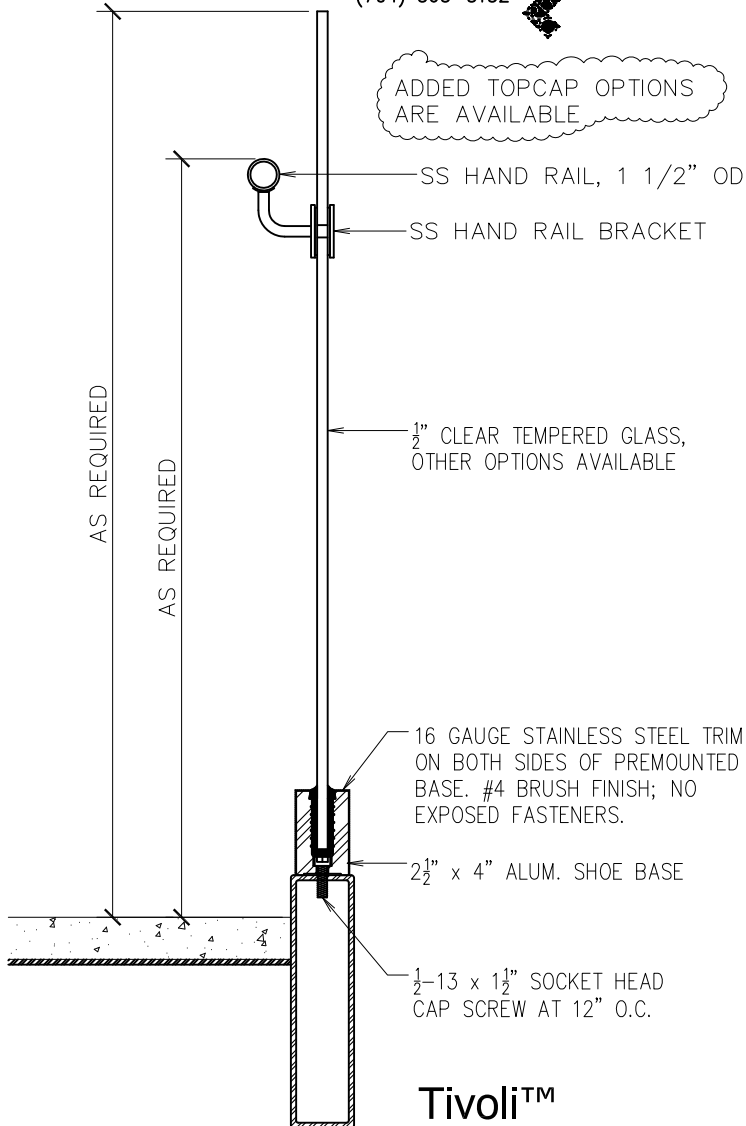

ADDED TOPCAP OPTIONS ARE AVAILABLE

RAIL DESIGN: Tivoli



Architectural Railings & Grilles
Fort Mill, SC
(704)-365-5152

Please visit our website for available options and materials.
www.stainless-railing.com

Tivoli™

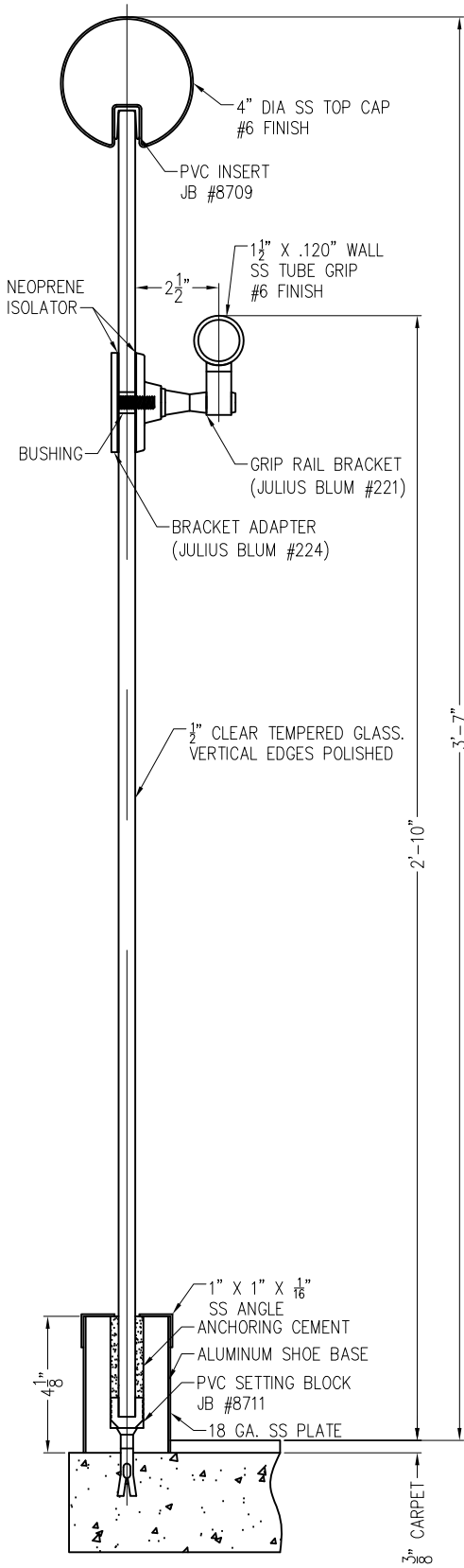

JOB # 192 LEVEL RAIL

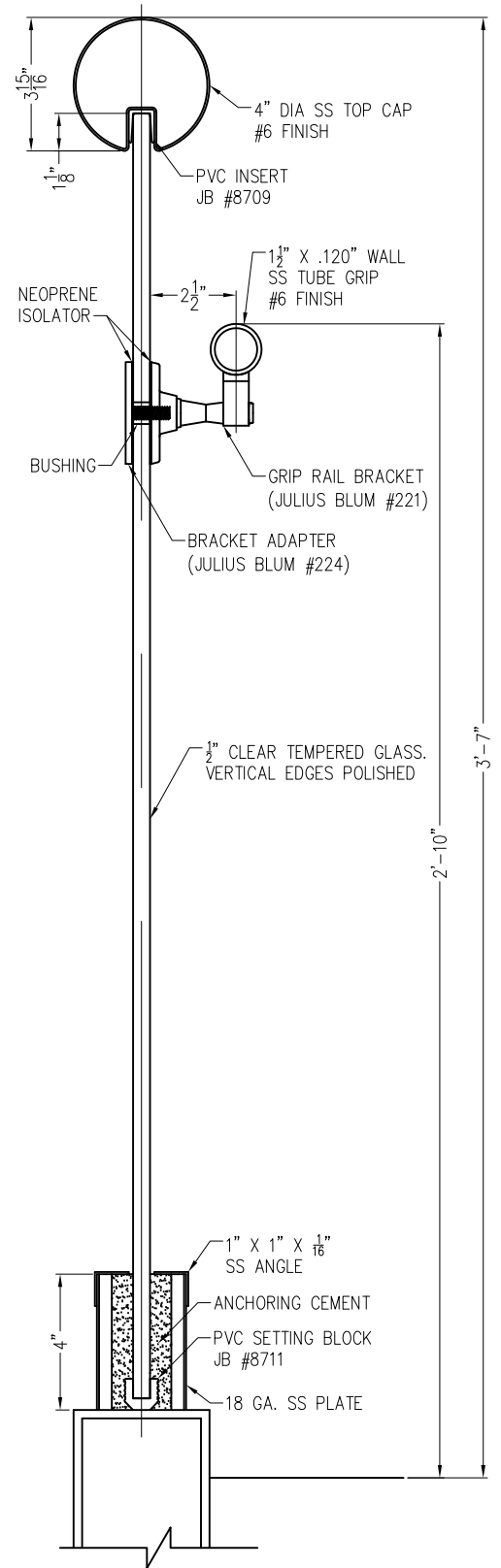

JOB # 192 STAIR RAIL

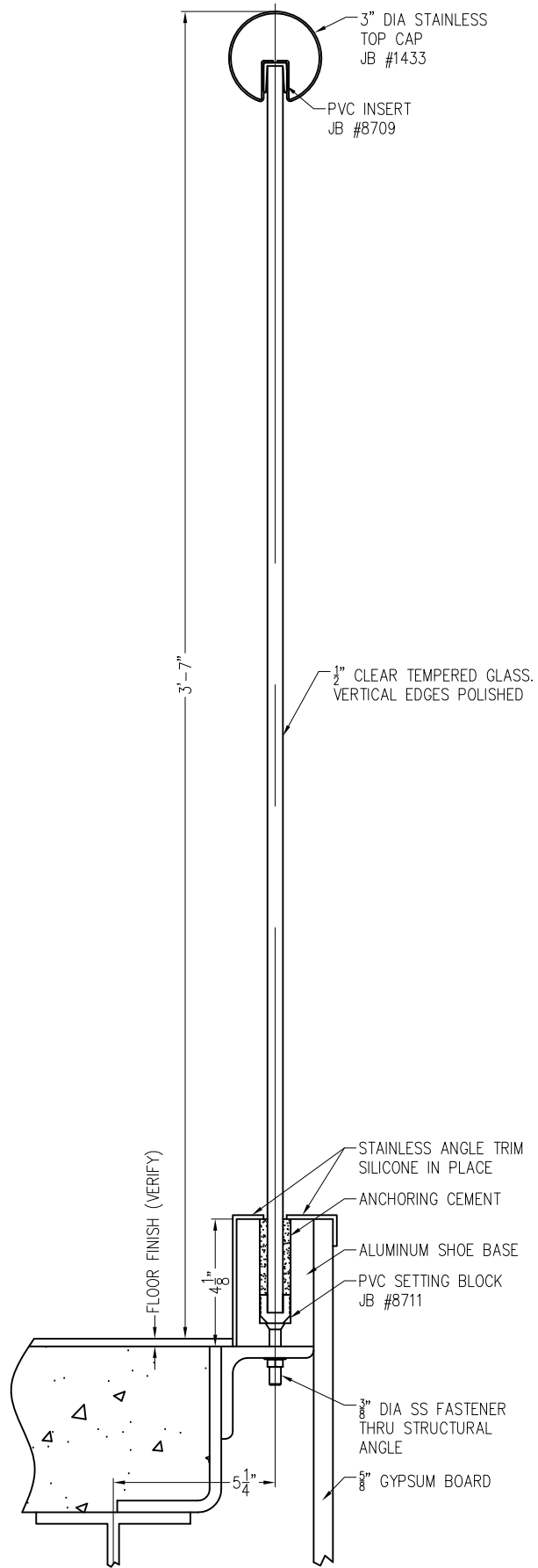

JOB # 256 LEVEL RAIL

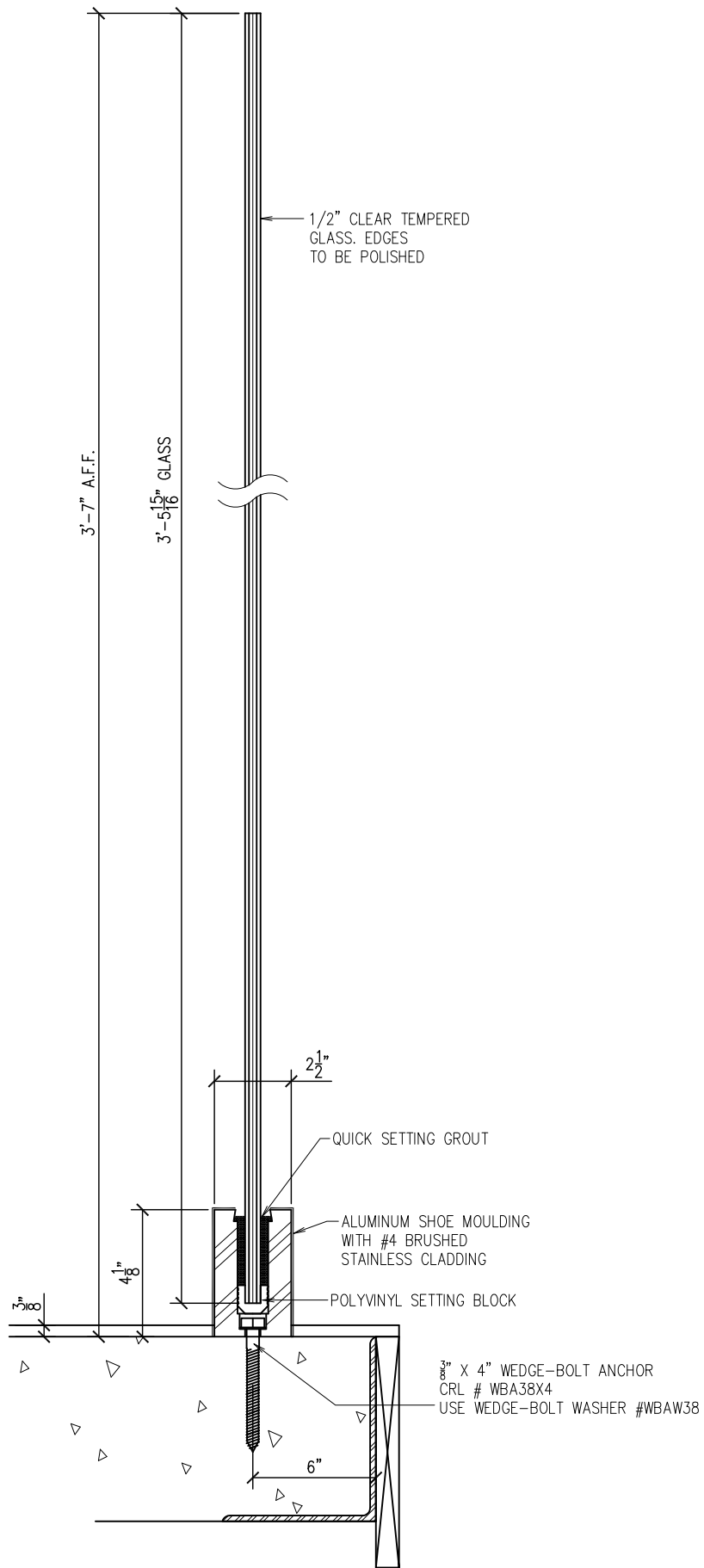

JOB # 587 LEVEL RAIL

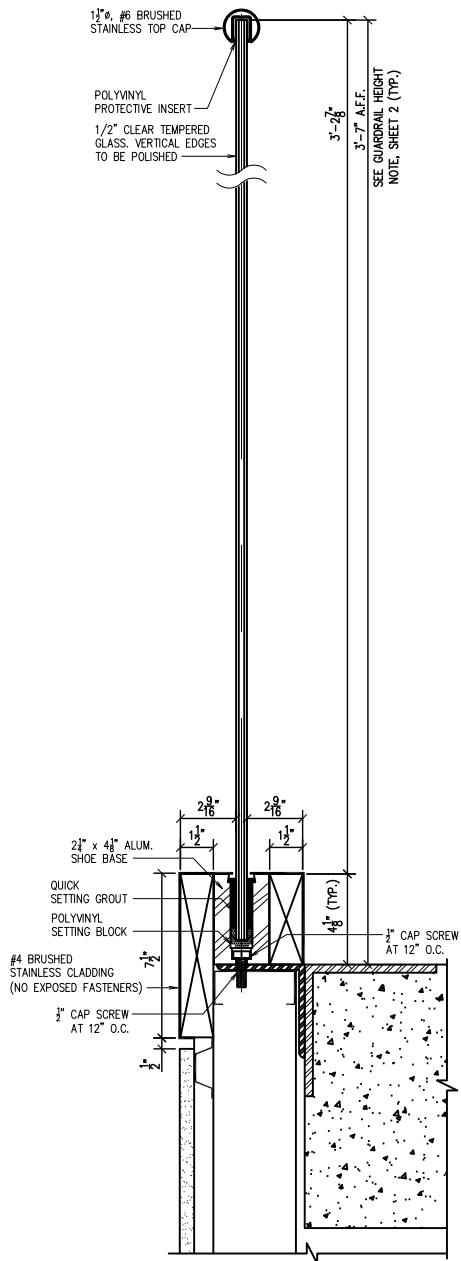

JOB # 656 LEVEL RAIL MOUNTING #1

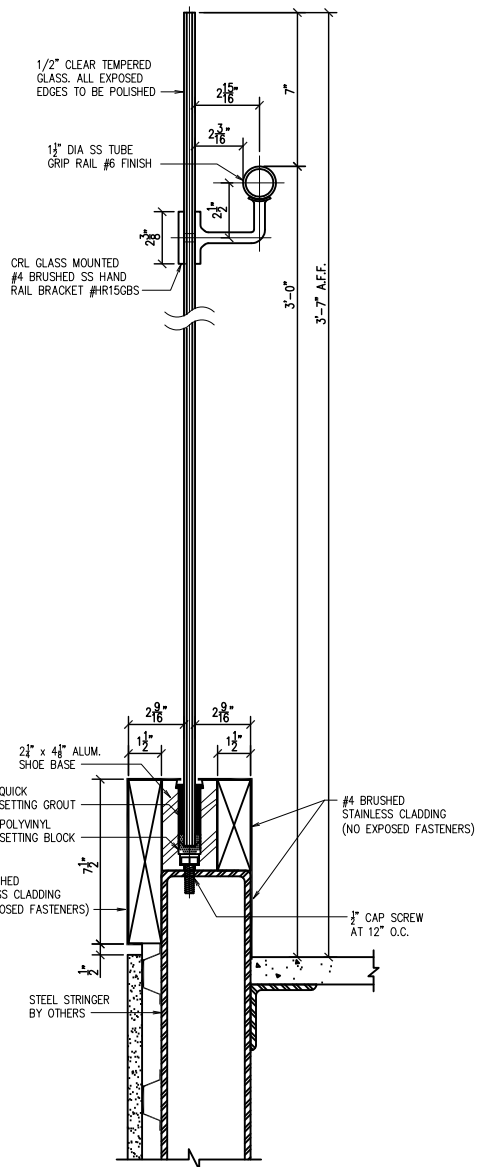

JOB # 656 STAIR RAIL MOUNTING #2

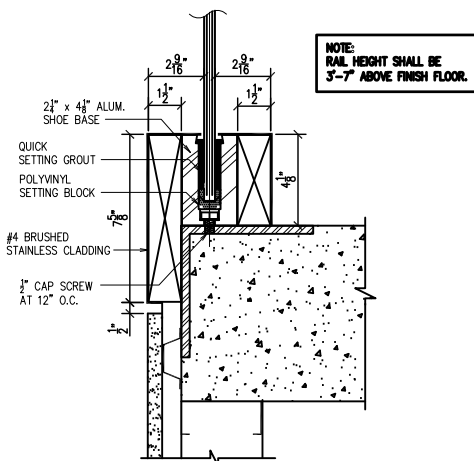

JOB # 656 LEVEL RAIL MOUNTING #3

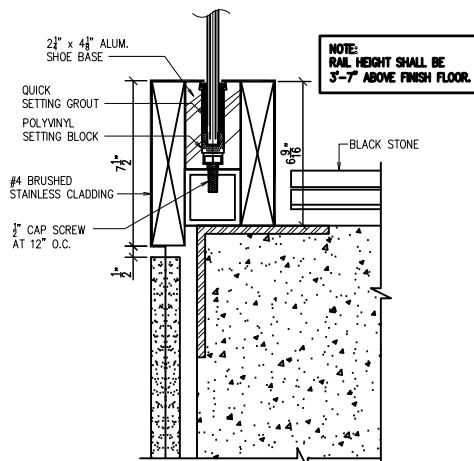

JOB # 656 LEVEL RAIL MOUNTING #4

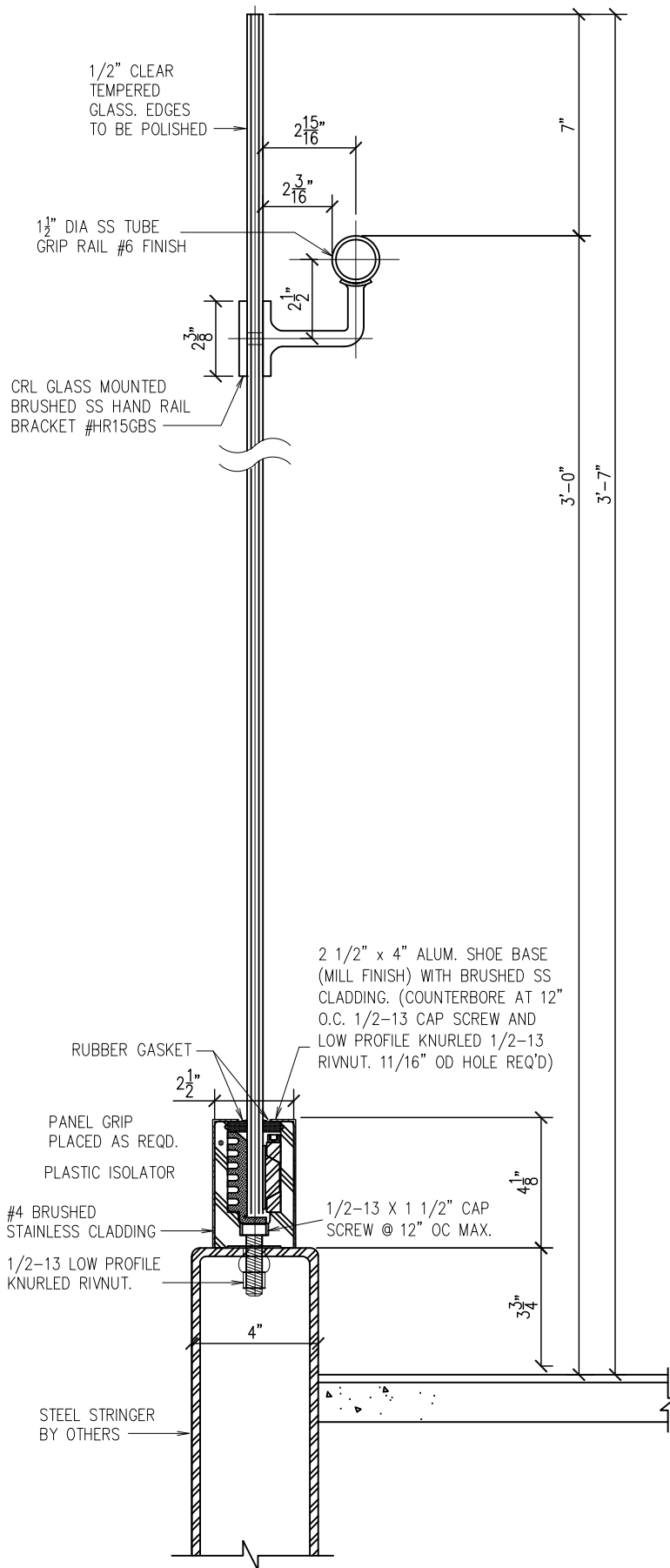

JOB # 679 STAIR RAIL

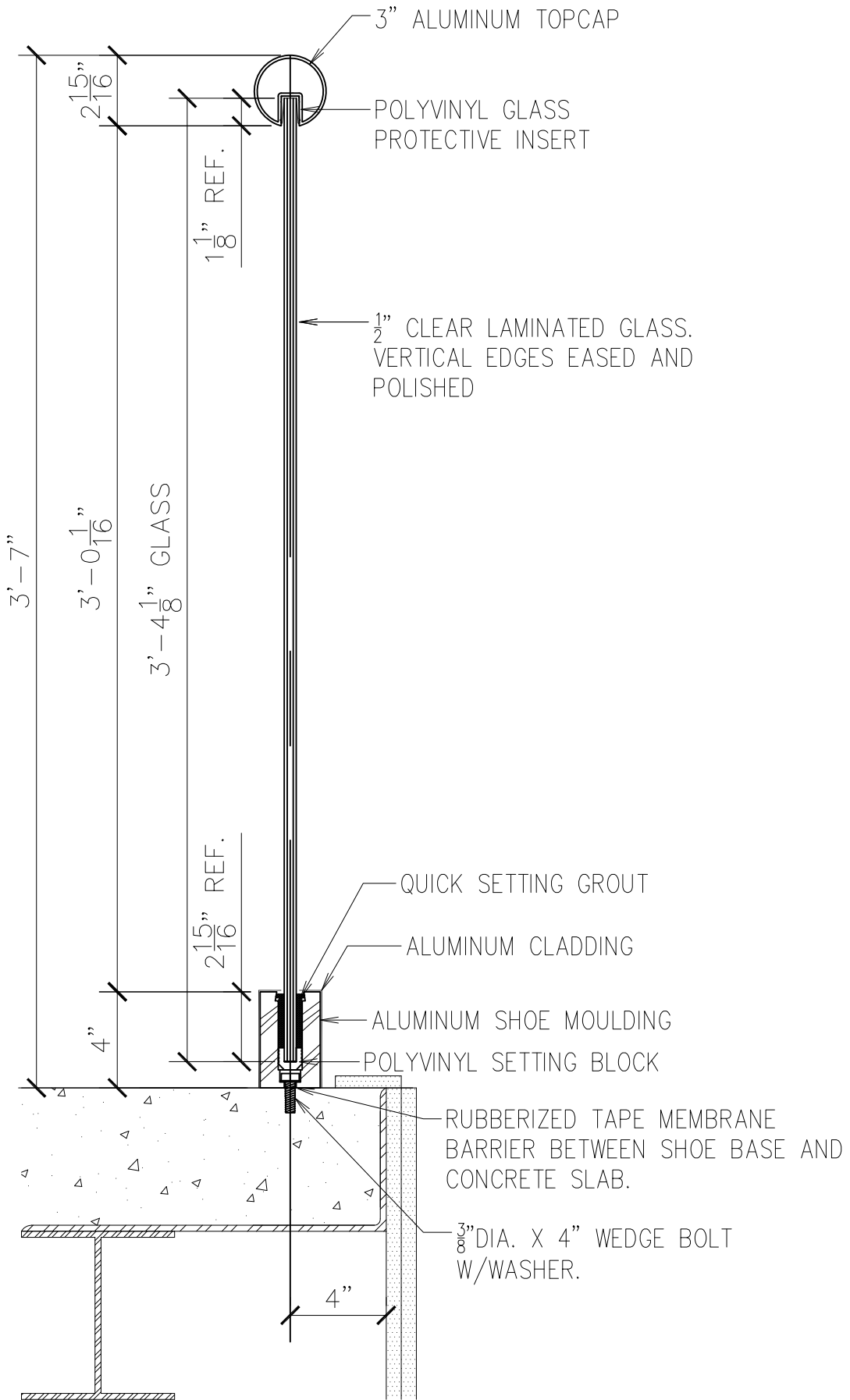

JOB # 688 LEVEL RAIL

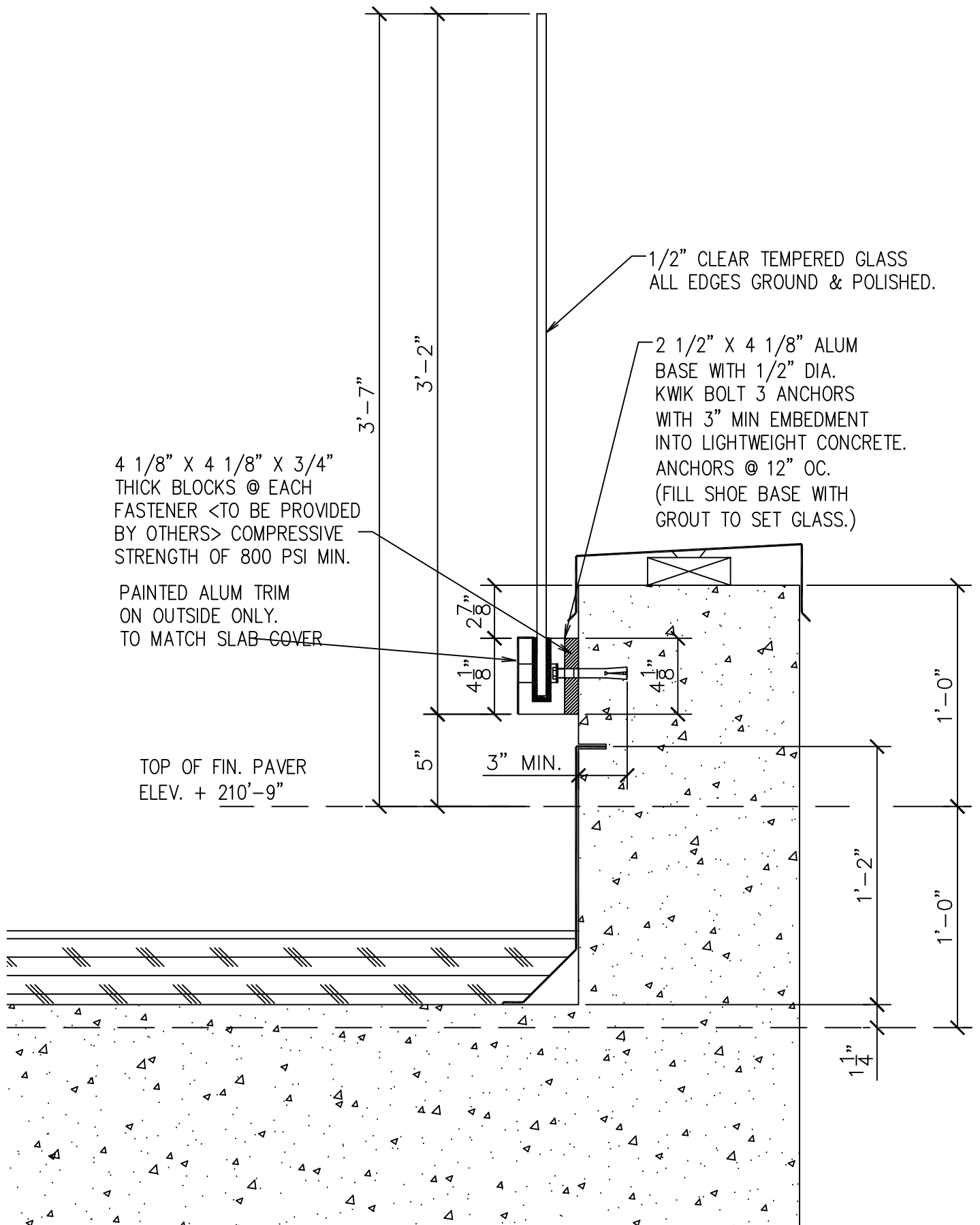

4 1/8" X 4 1/8" X 3/4"
THICK BLOCKS @ EACH
FASTENER <TO BE PROVIDED
BY OTHERS> COMPRESSIVE
STRENGTH OF 800 PSI MIN.

PAINTED ALUM TRIM
ON OUTSIDE ONLY.
TO MATCH SLAB COVER

TOP OF FIN. PAVER
ELEV. + 210'-9"

1/2" CLEAR TEMPERED GLASS
ALL EDGES GROUND & POLISHED.

2 1/2" X 4 1/8" ALUM
BASE WITH 1/2" DIA.
KWIK BOLT 3 ANCHORS
WITH 3" MIN EMBEDMENT
INTO LIGHTWEIGHT CONCRETE.
ANCHORS @ 12" OC.
(FILL SHOE BASE WITH
GROUT TO SET GLASS.)

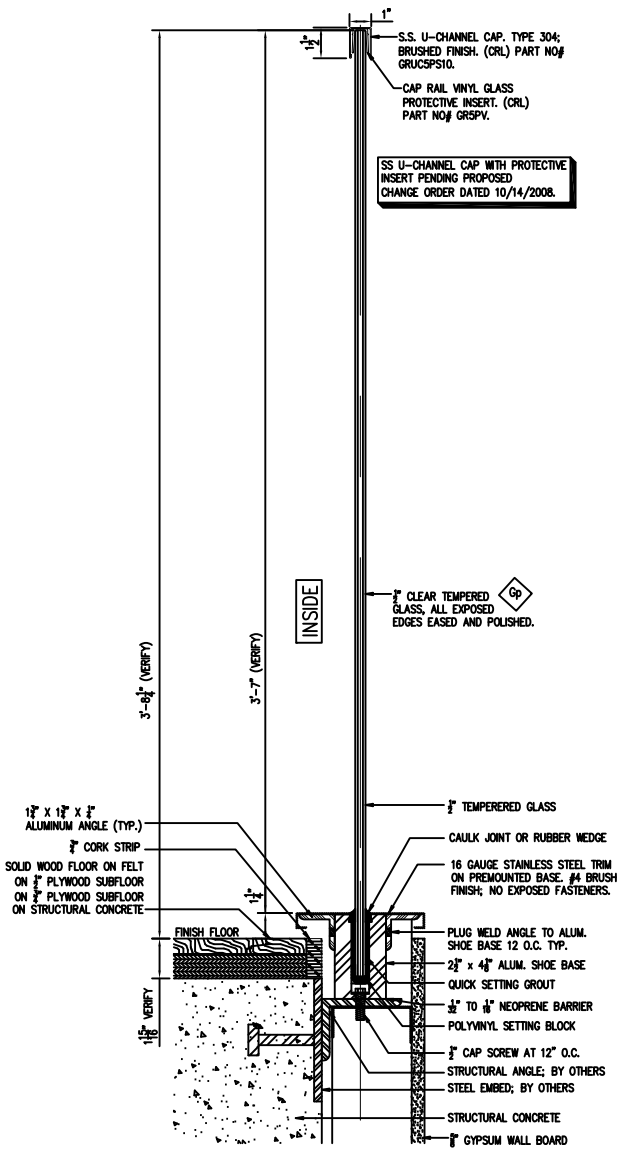

JOB # 718 LEVEL RAIL

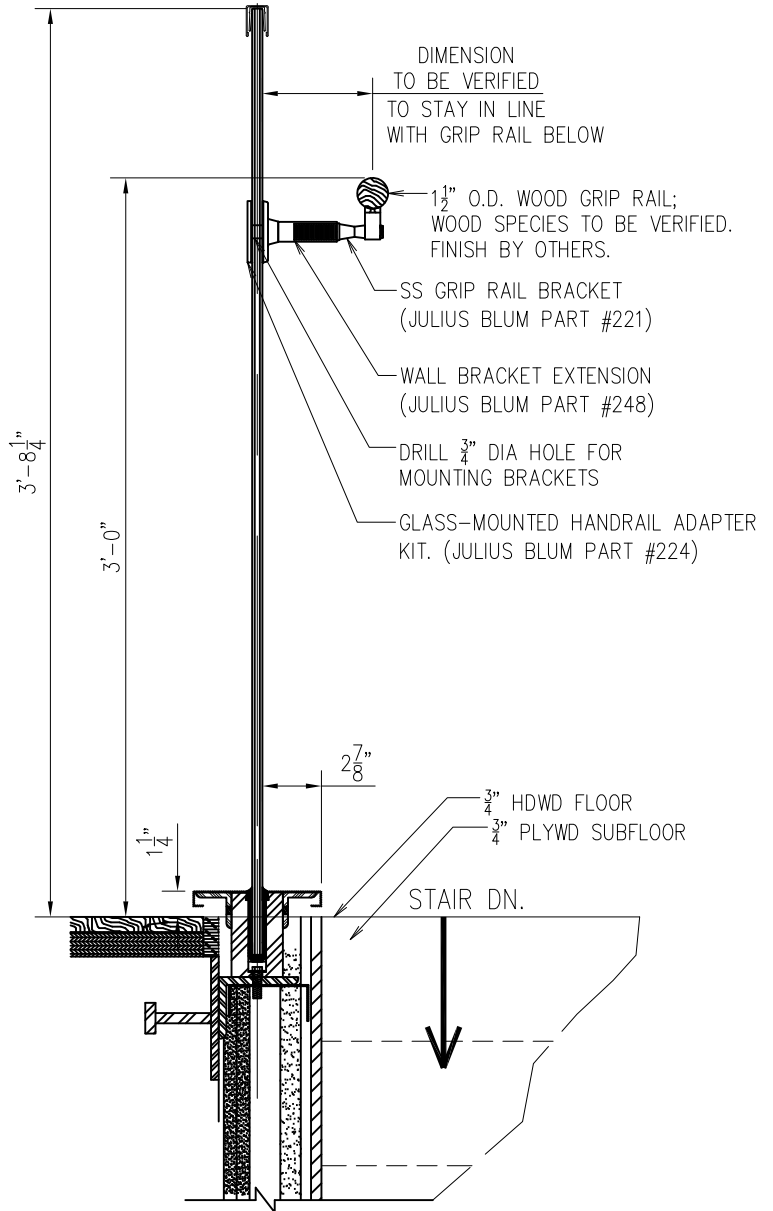

JOB # 718 STAIR RAIL

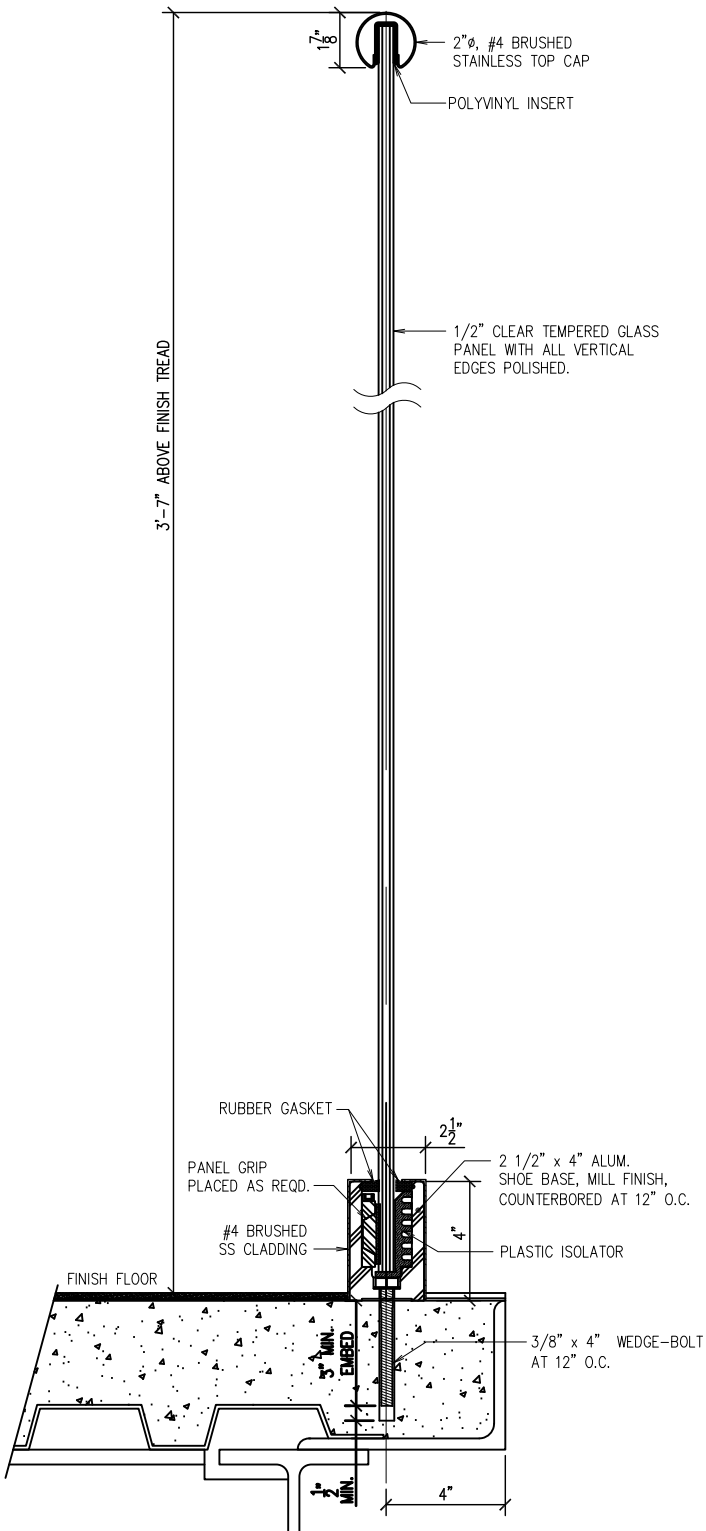

JOB # 751 LEVEL RAIL

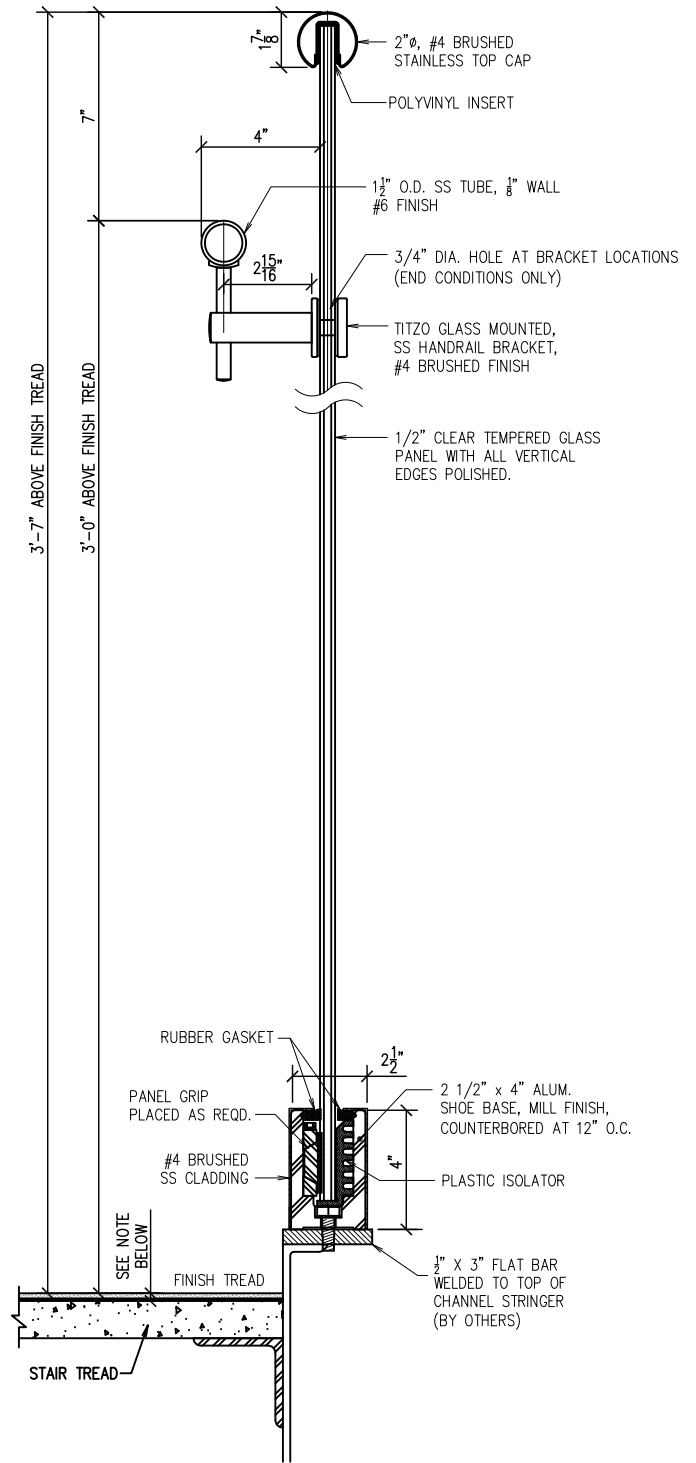

JOB # 751 STAIR RAIL

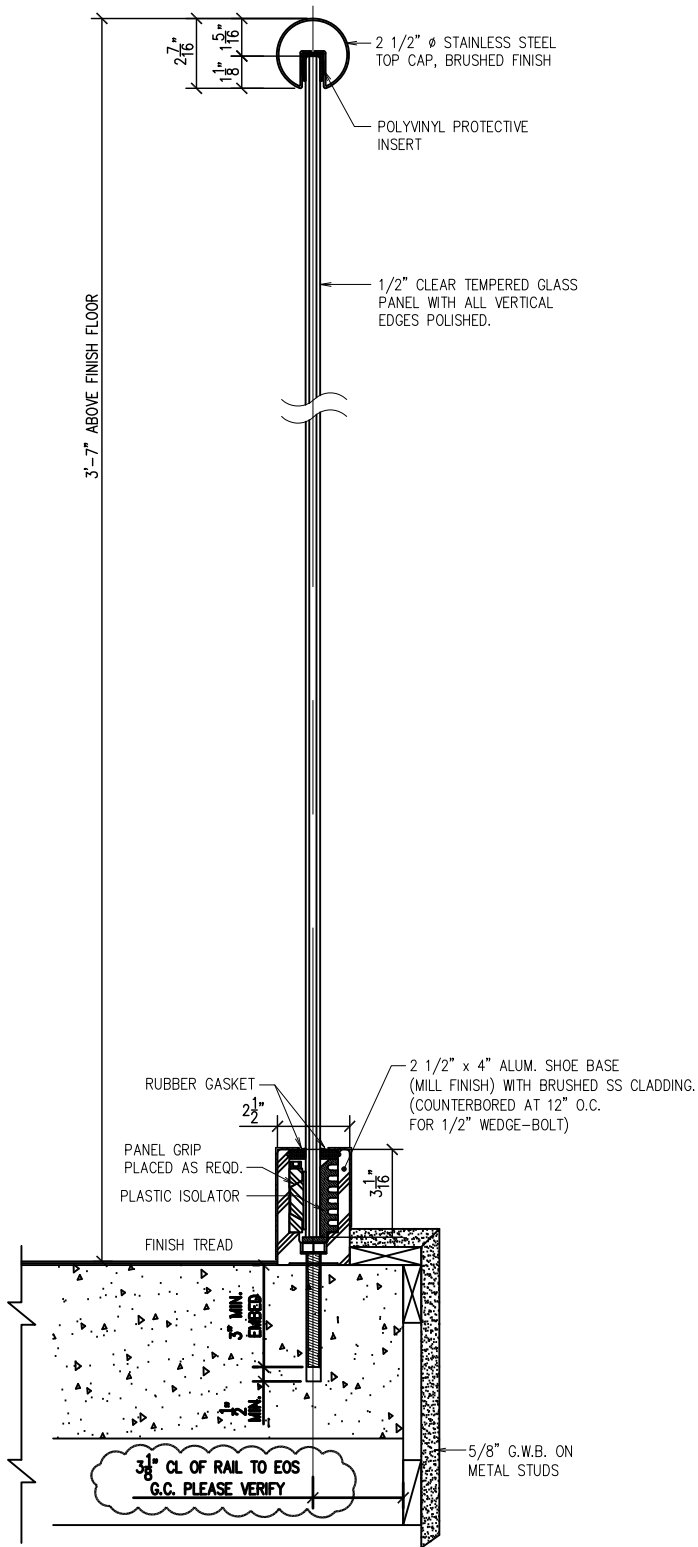

JOB # 758 LEVEL RAIL

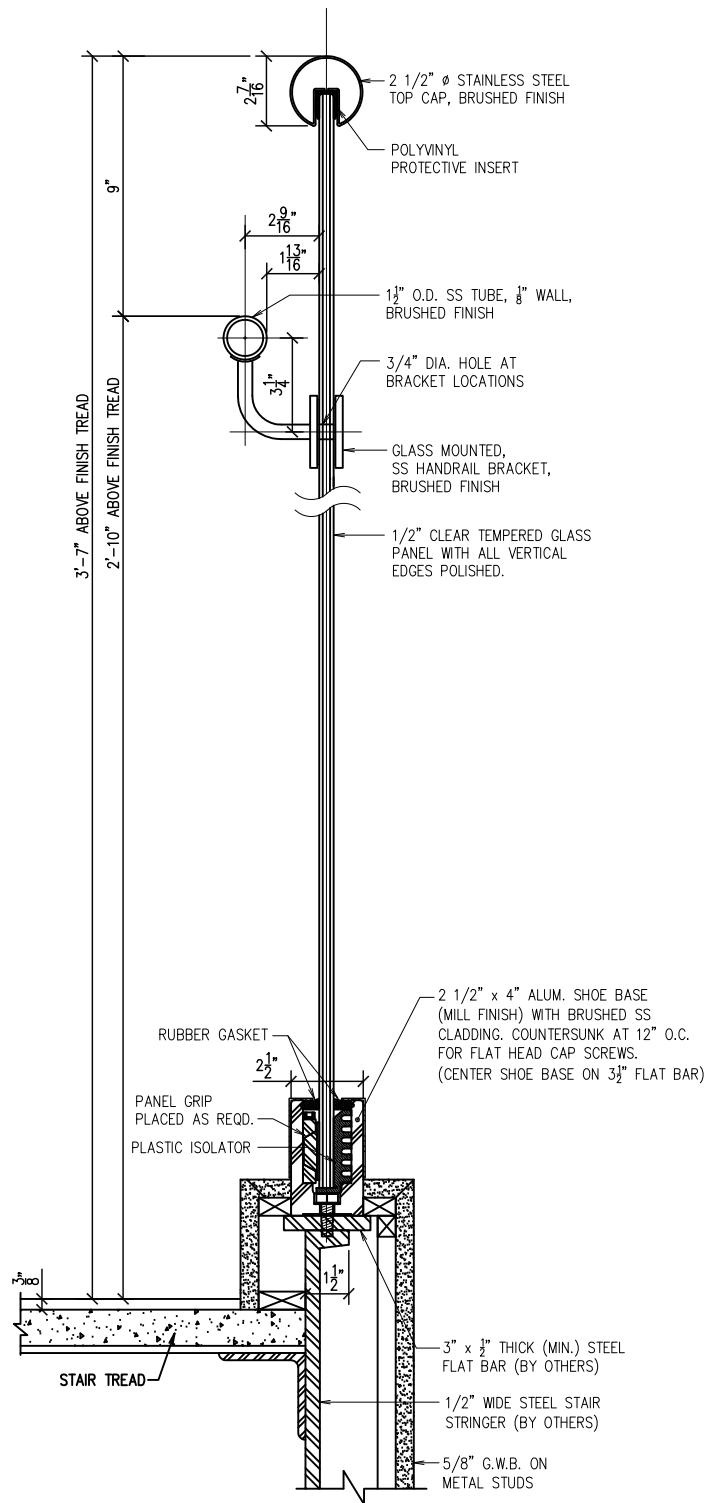

JOB # 758 STAIR RAIL

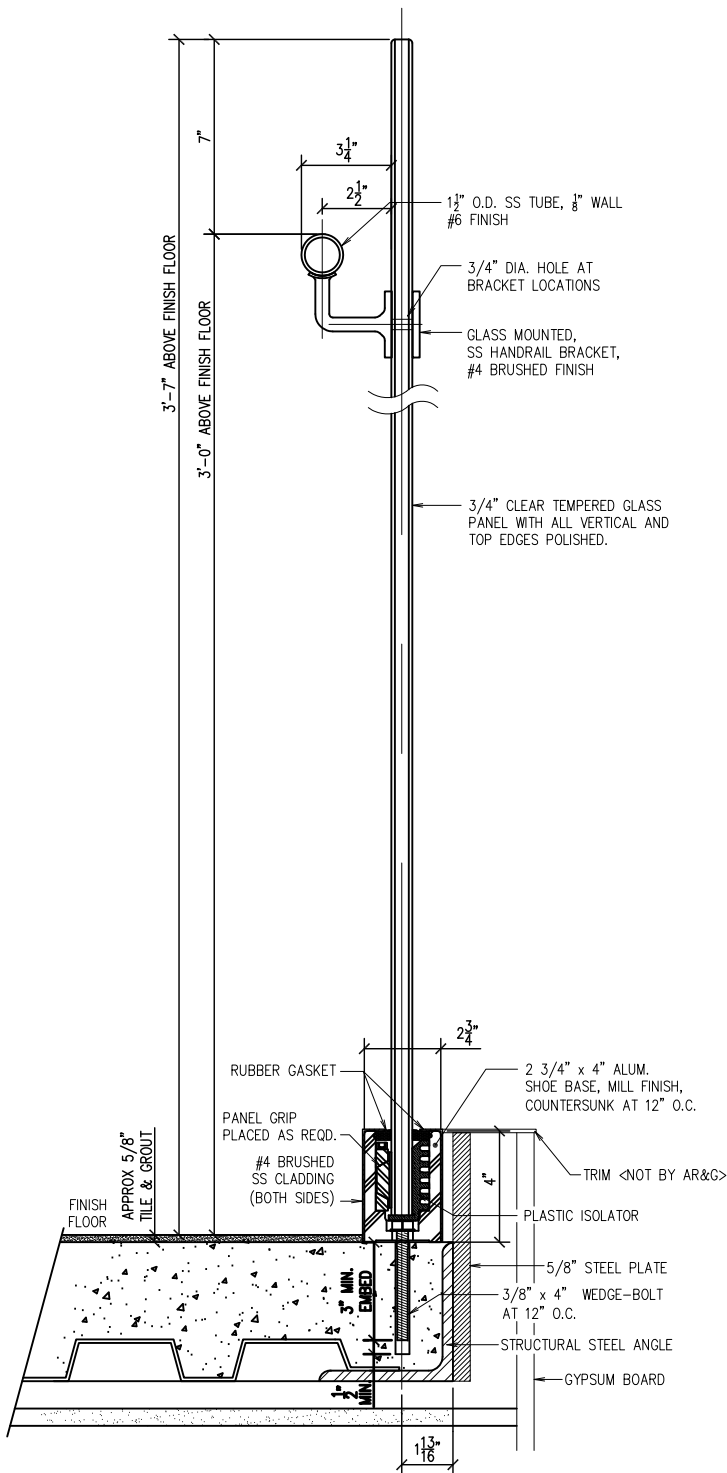

JOB # 764 LEVEL RAIL

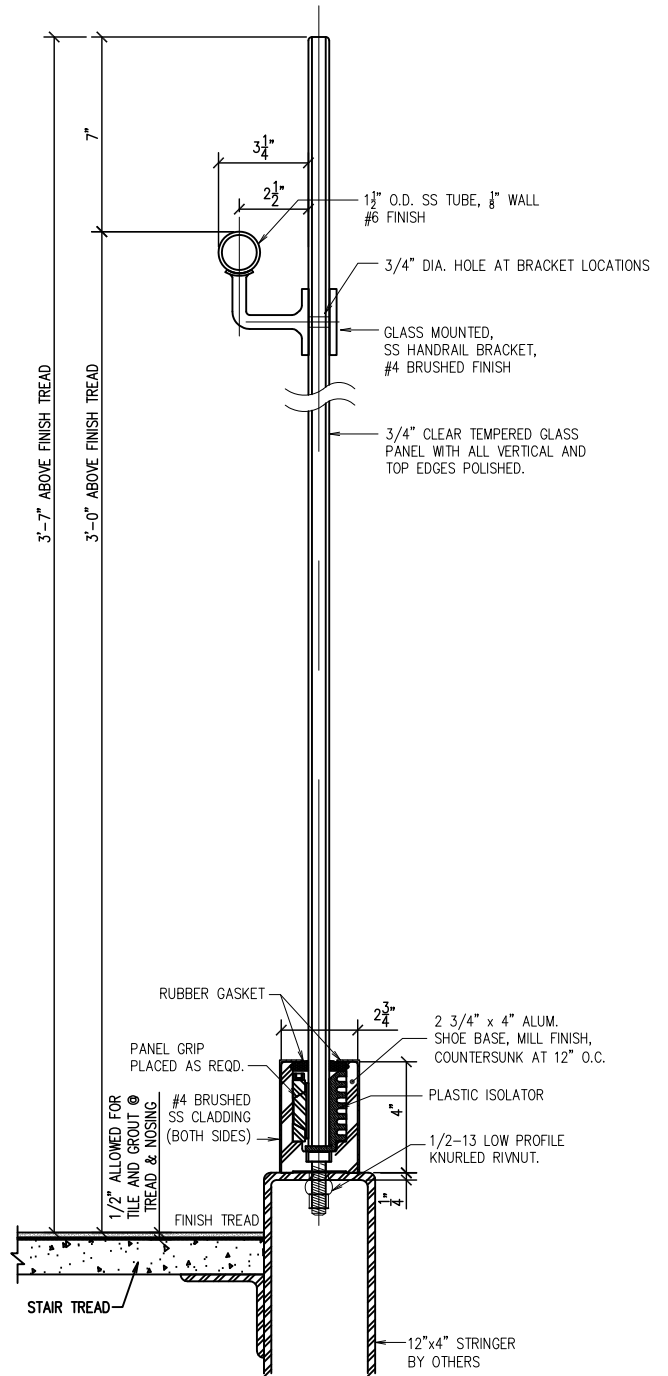

JOB # 764 STAIR RAIL

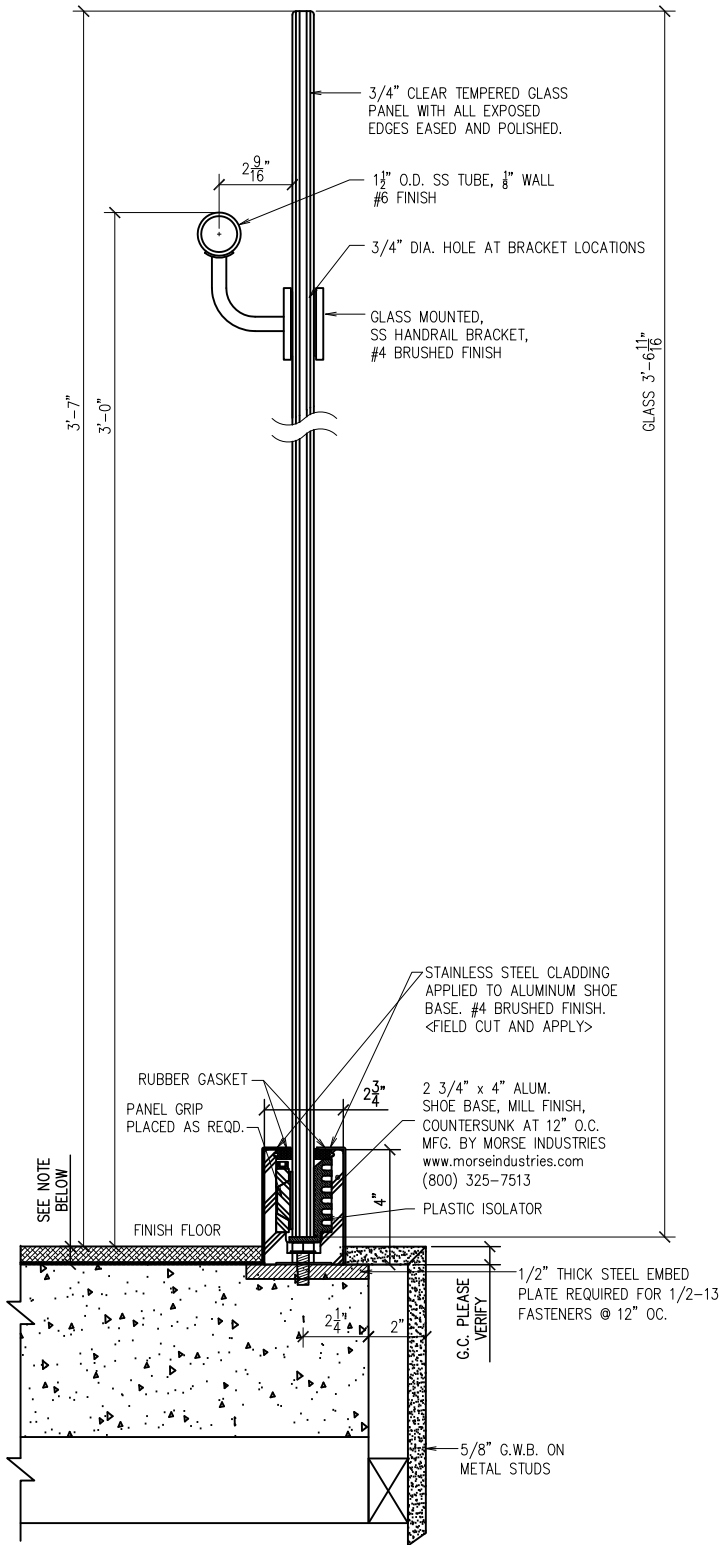

JOB # 770 LEVEL RAIL

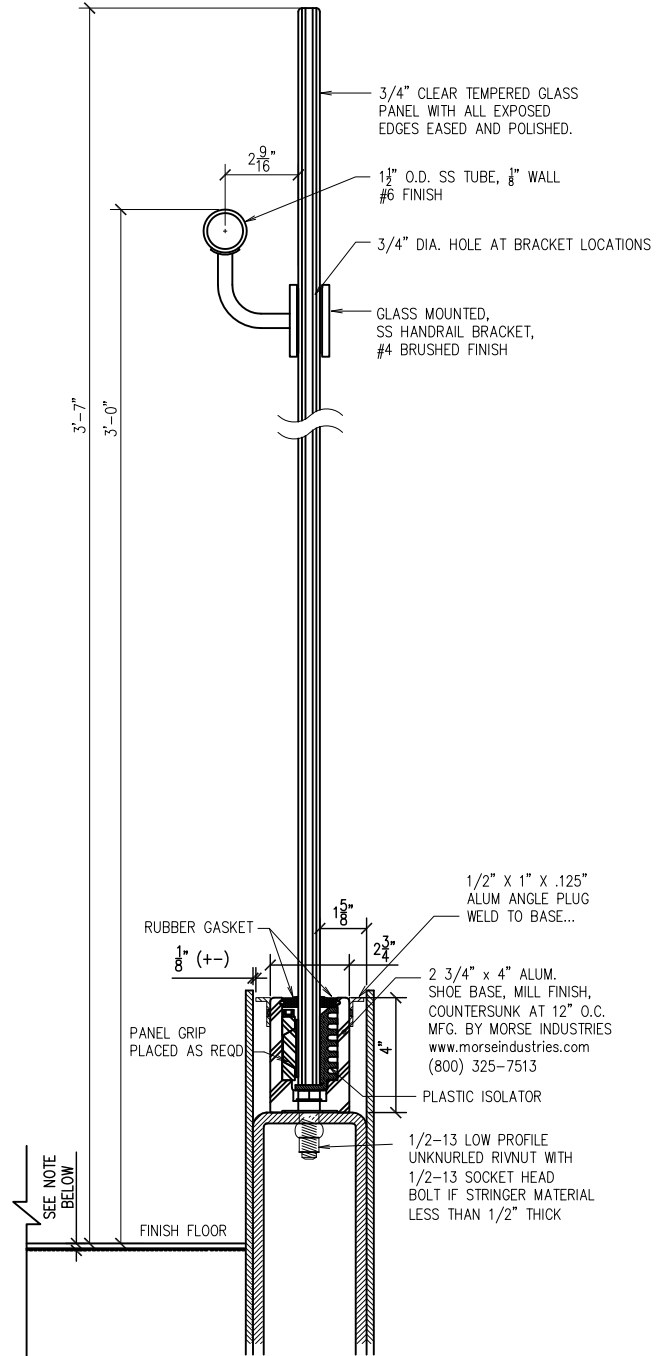

JOB # 770 STAIR RAIL

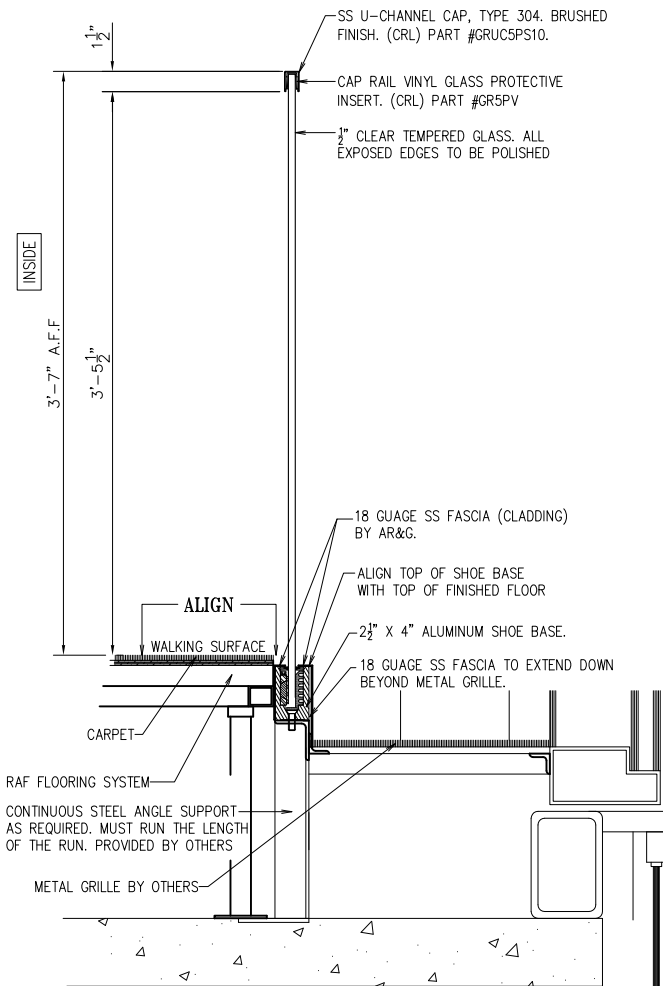

JOB # 772 LEVEL RAIL

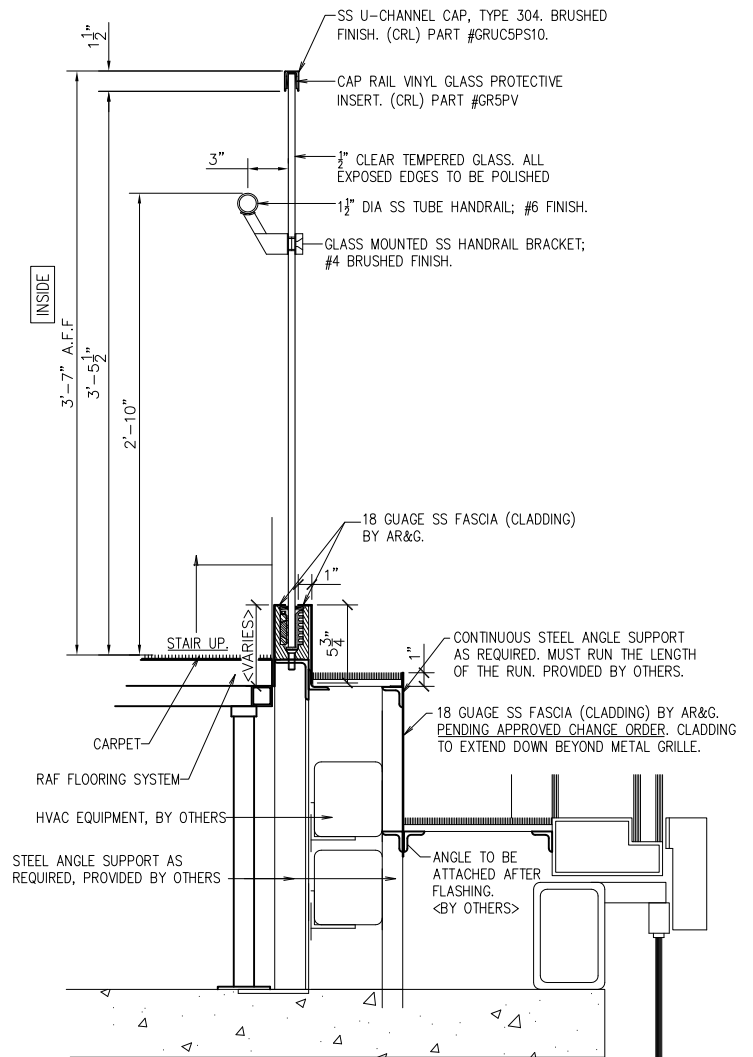

JOB # 772 STAIR RAIL

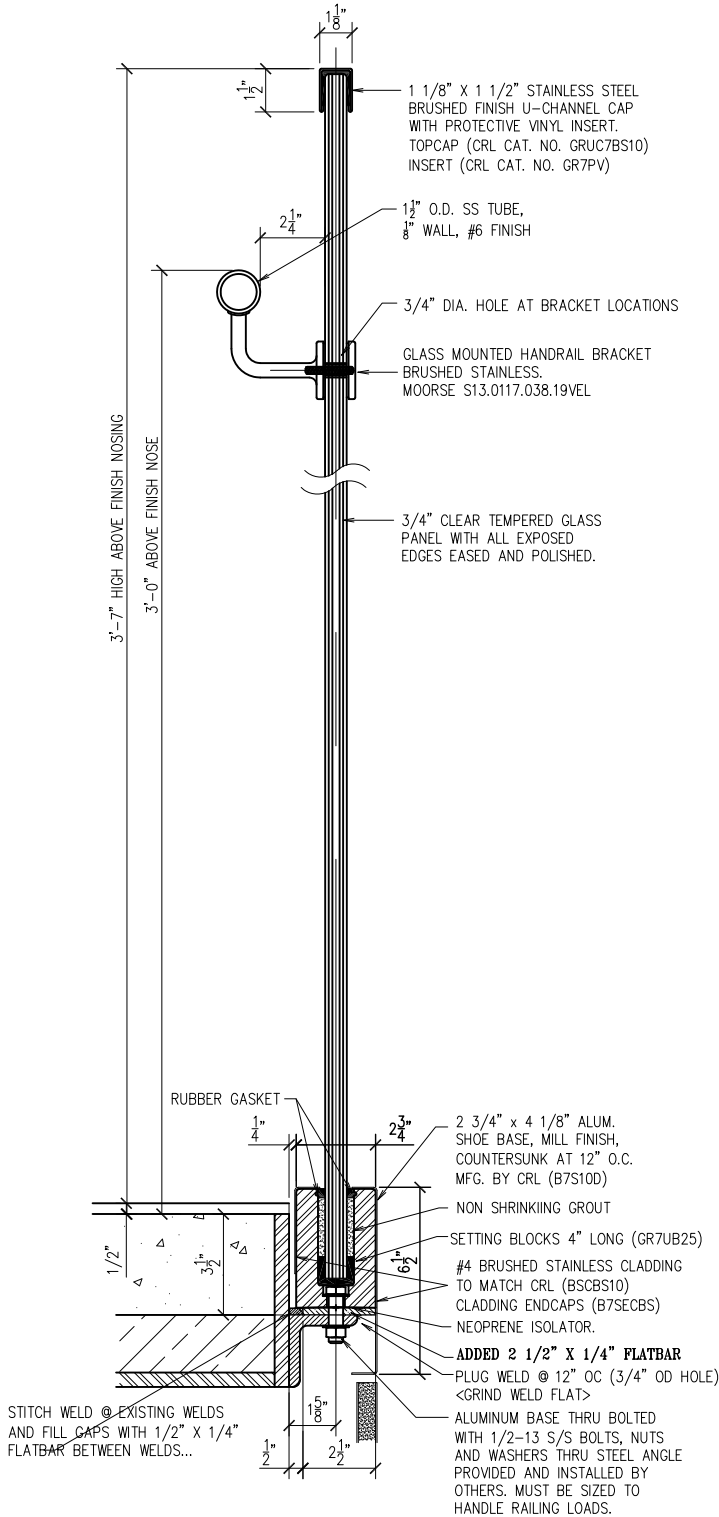

JOB # 775 LEVEL RAIL

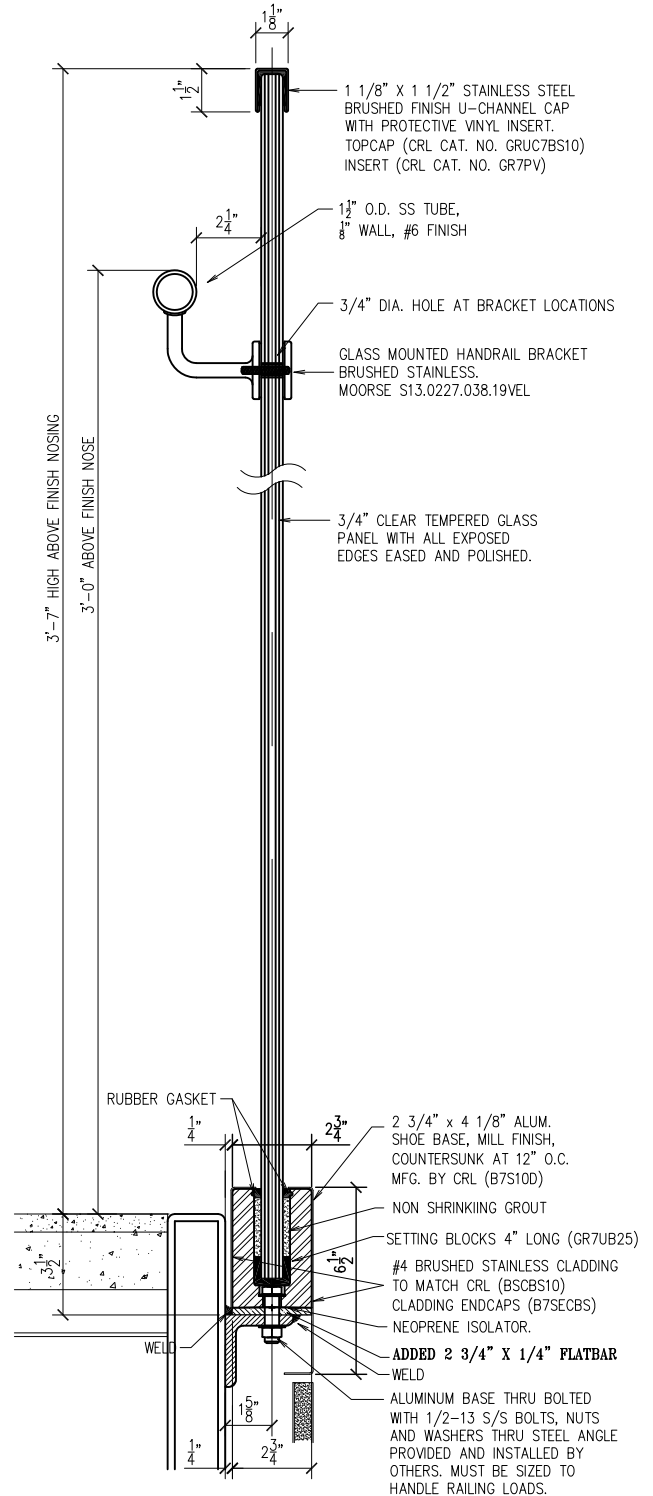

JOB # 775 STAIR RAIL

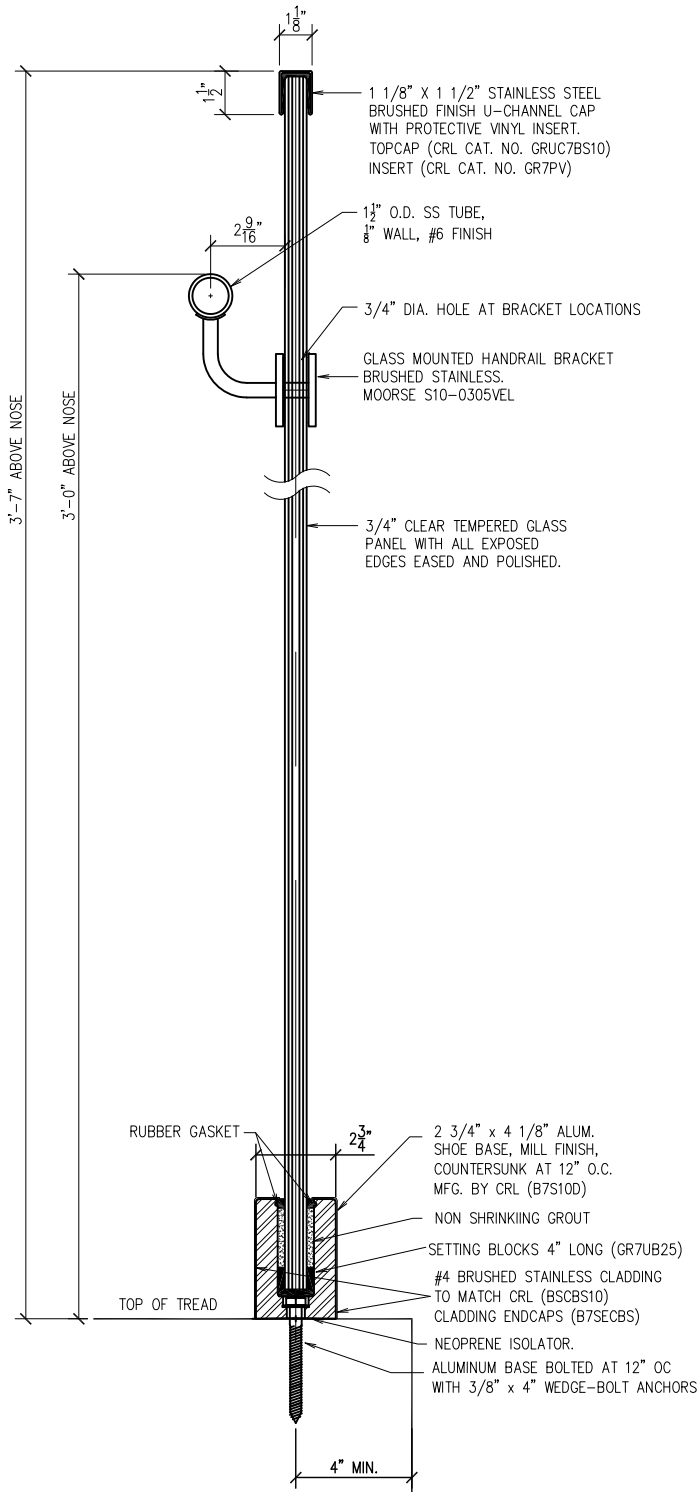

JOB # 775 LEVEL RAIL

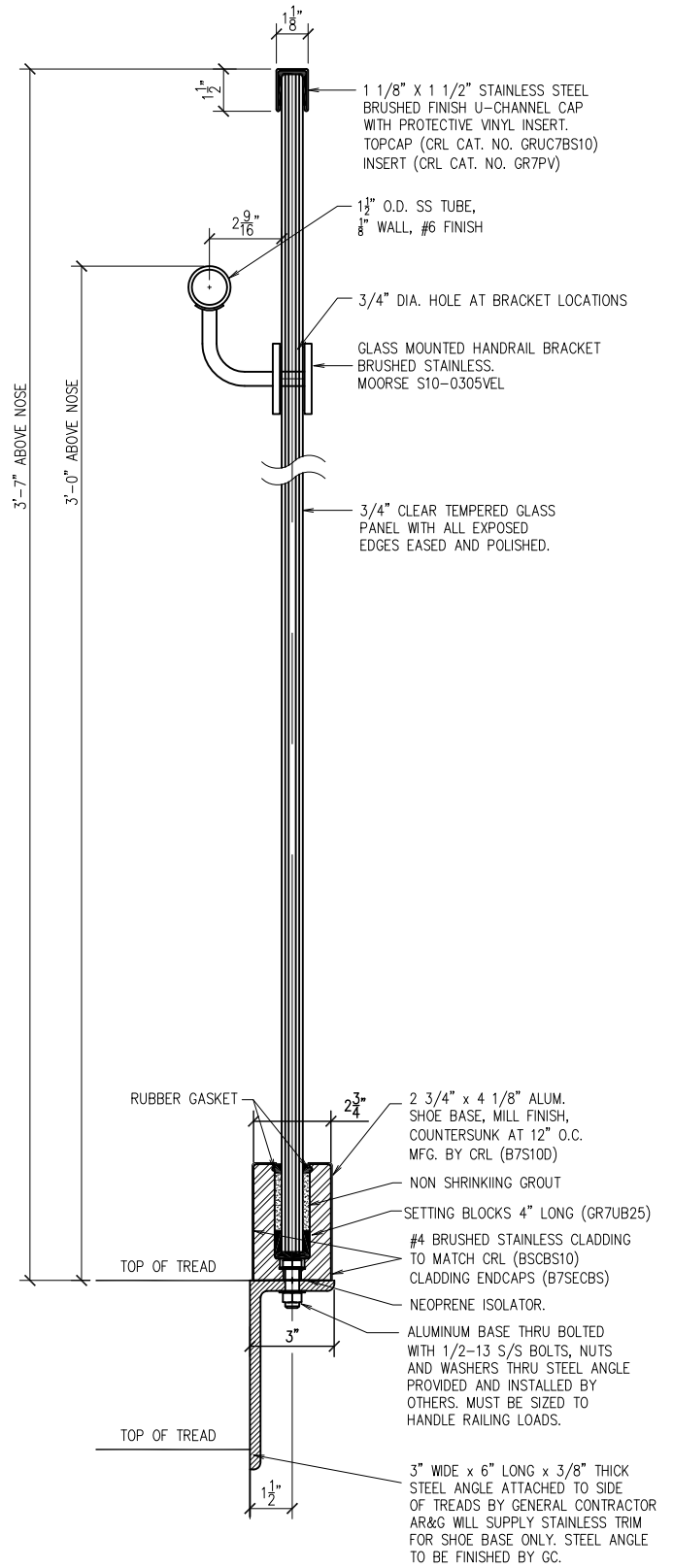

JOB # 775 STAIR RAIL

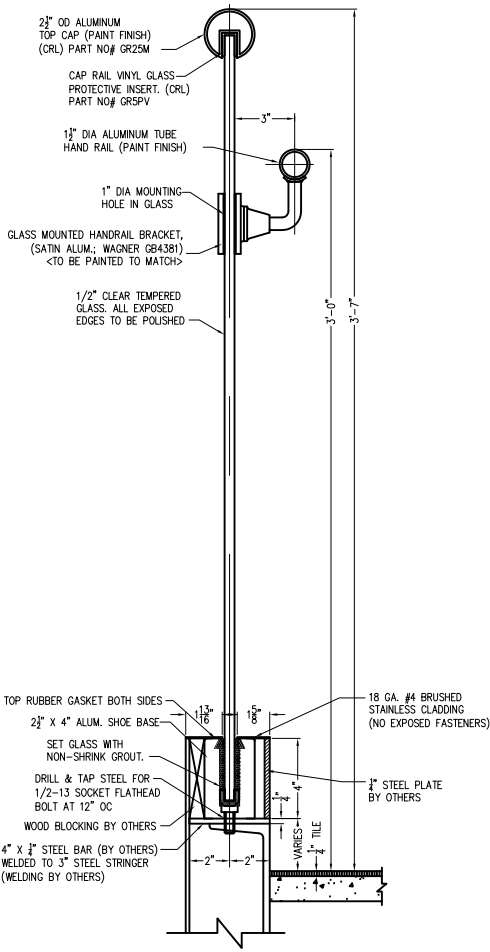

SECTION THRU - STAIR & LANDING RAIL 'GS'

JOB # 797 LEVEL AND STAIR RAIL

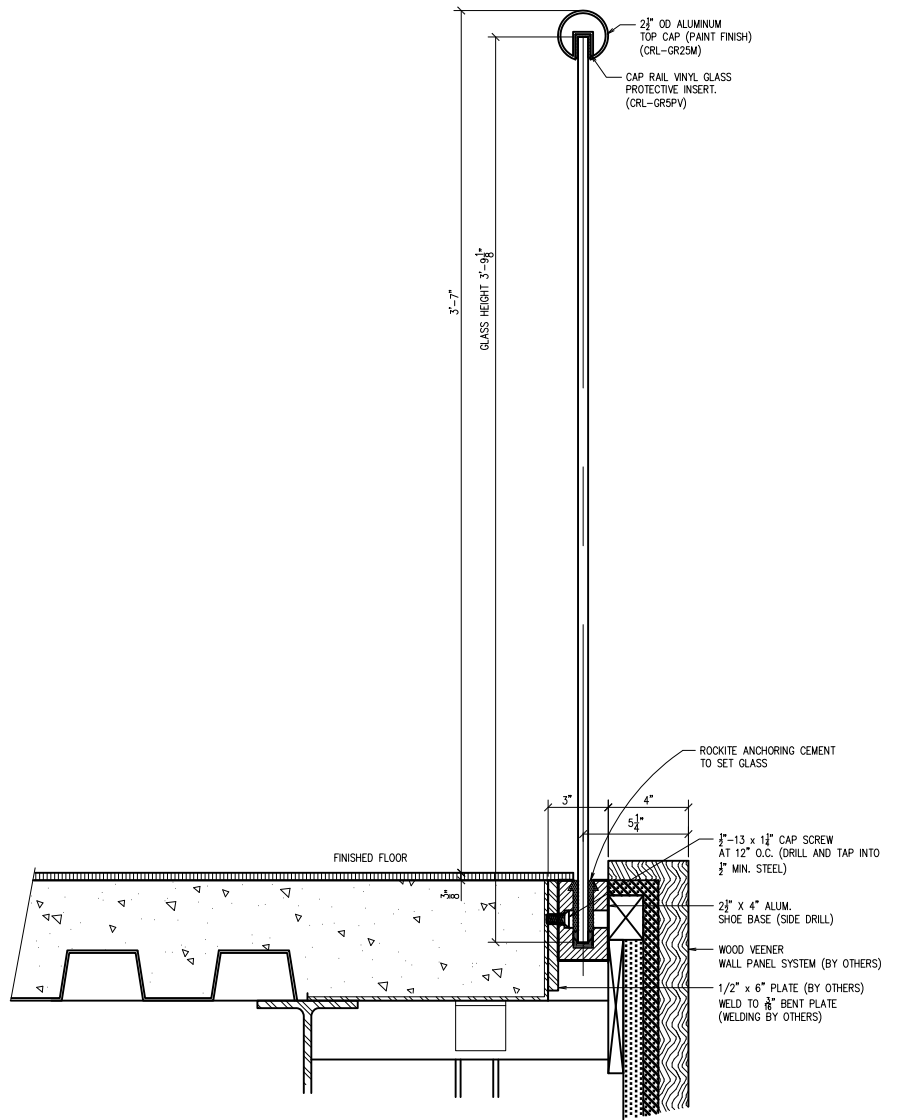

JOB # 797 LEVEL RAIL

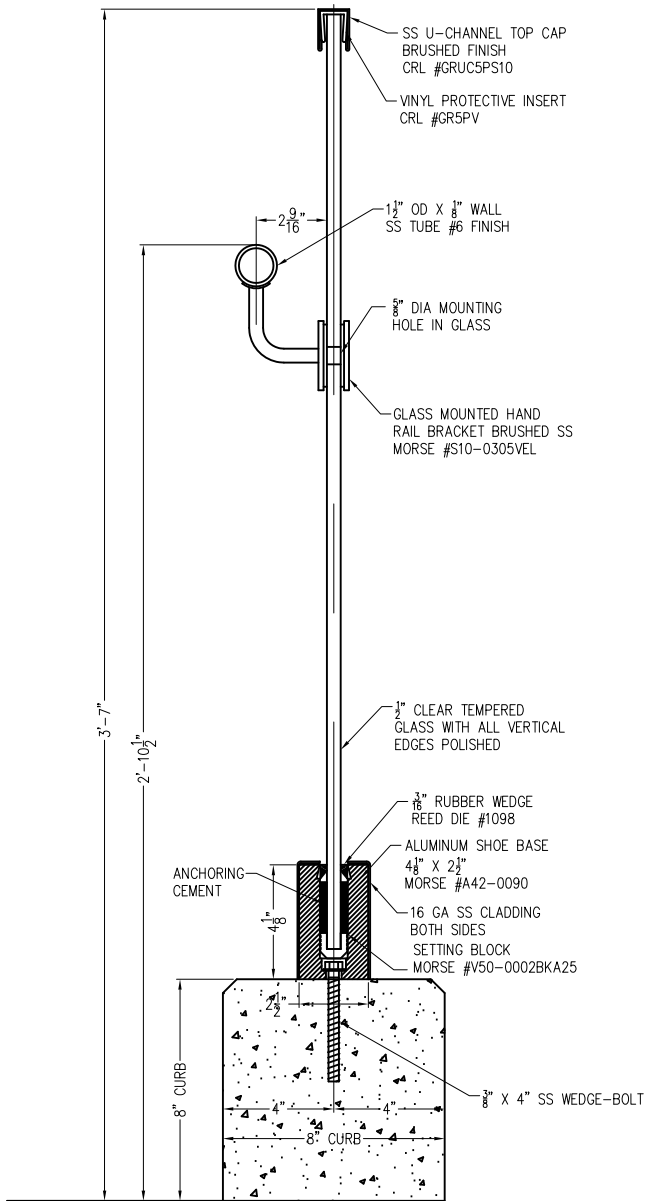

JOB # 813 LEVEL RAIL

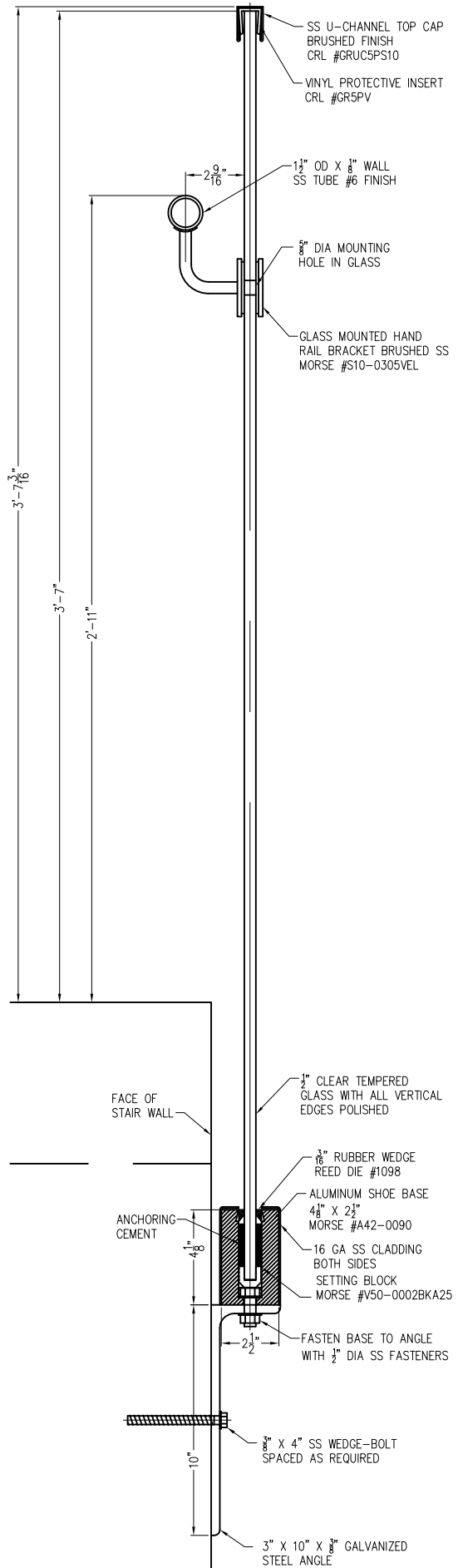

JOB # 813 STAIR RAIL

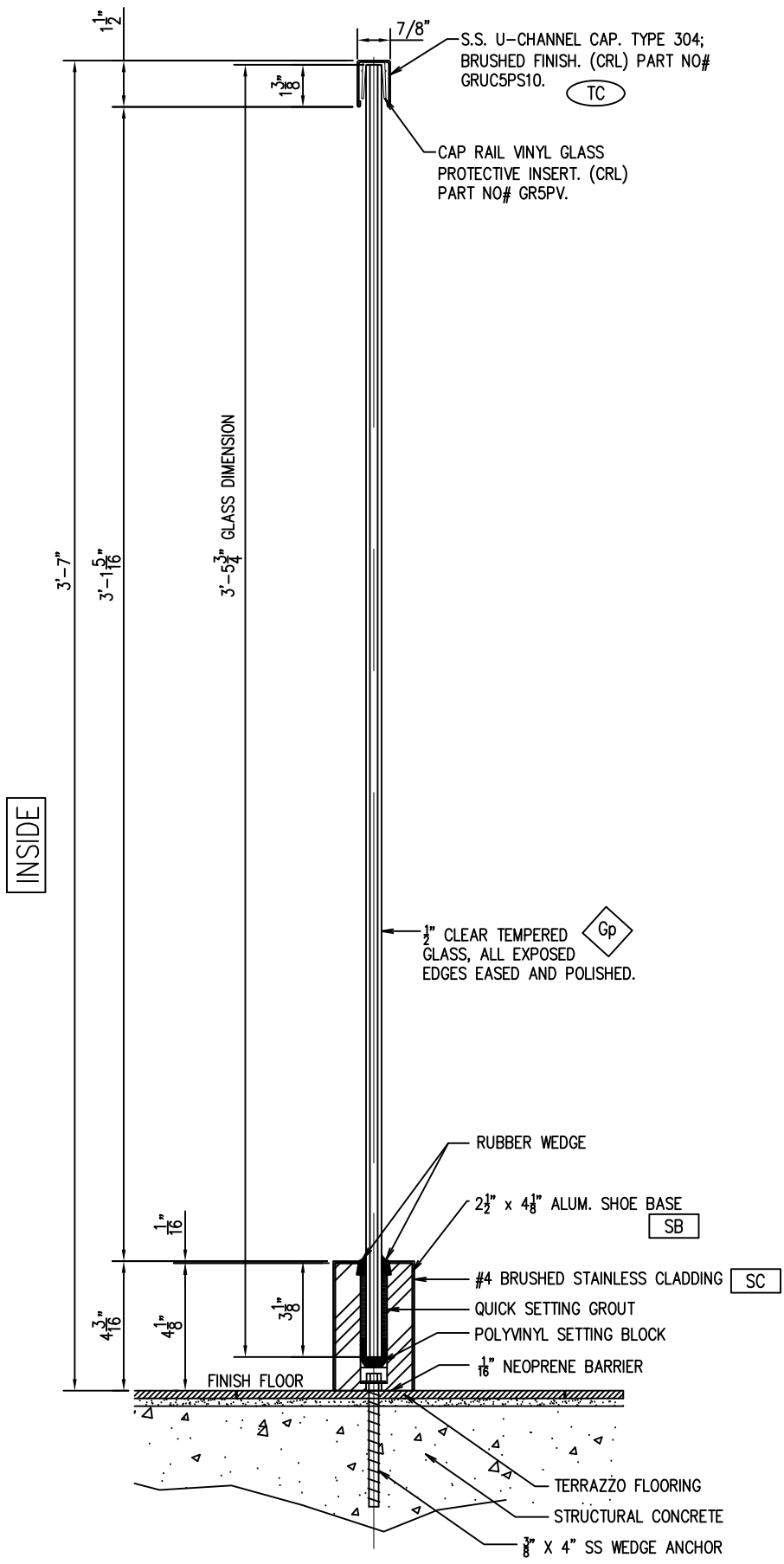

JOB # 833 LEVEL RAIL

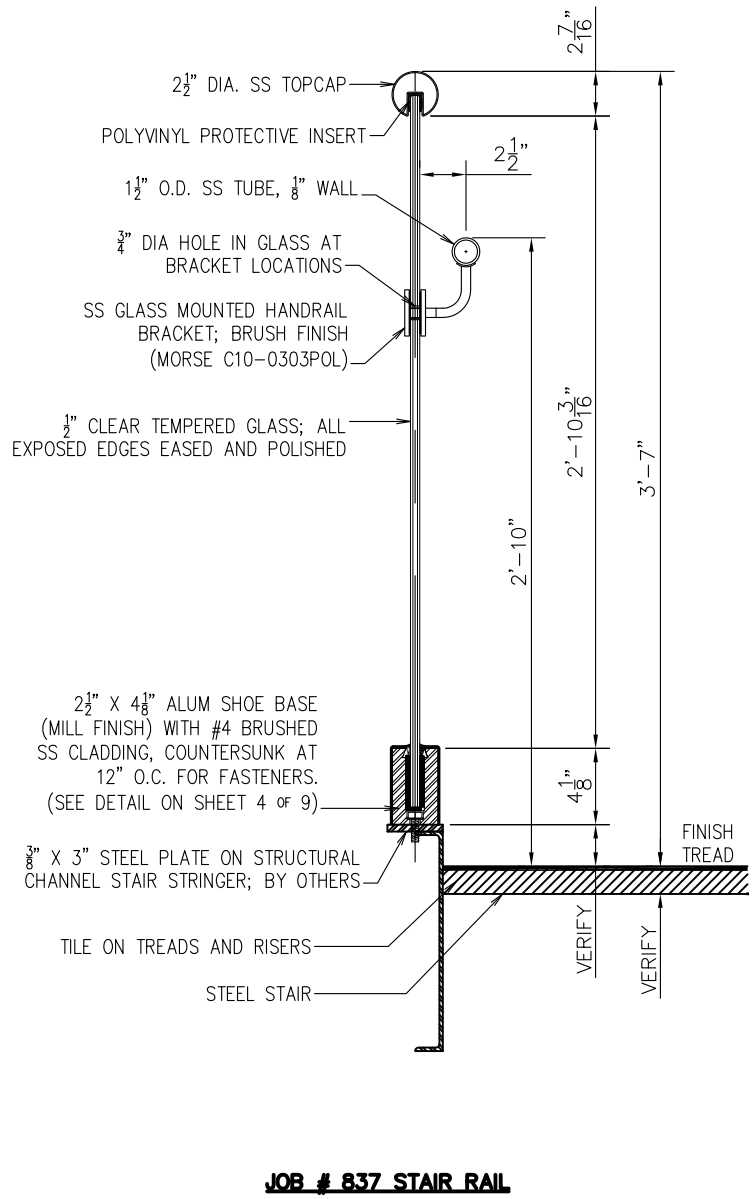
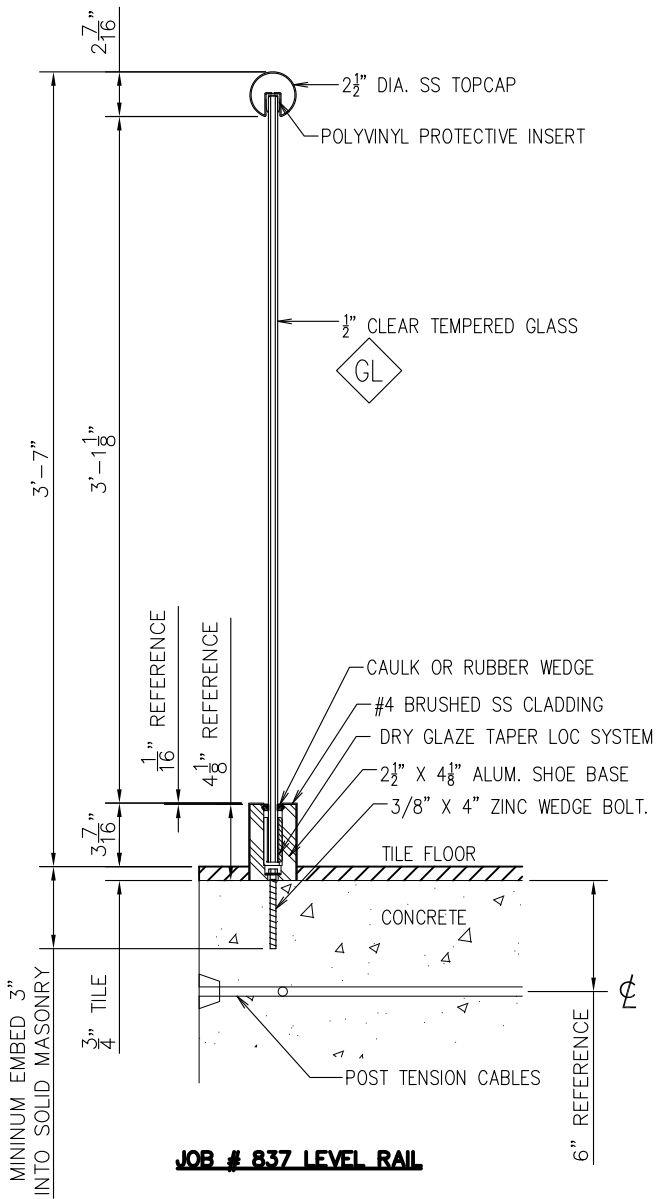

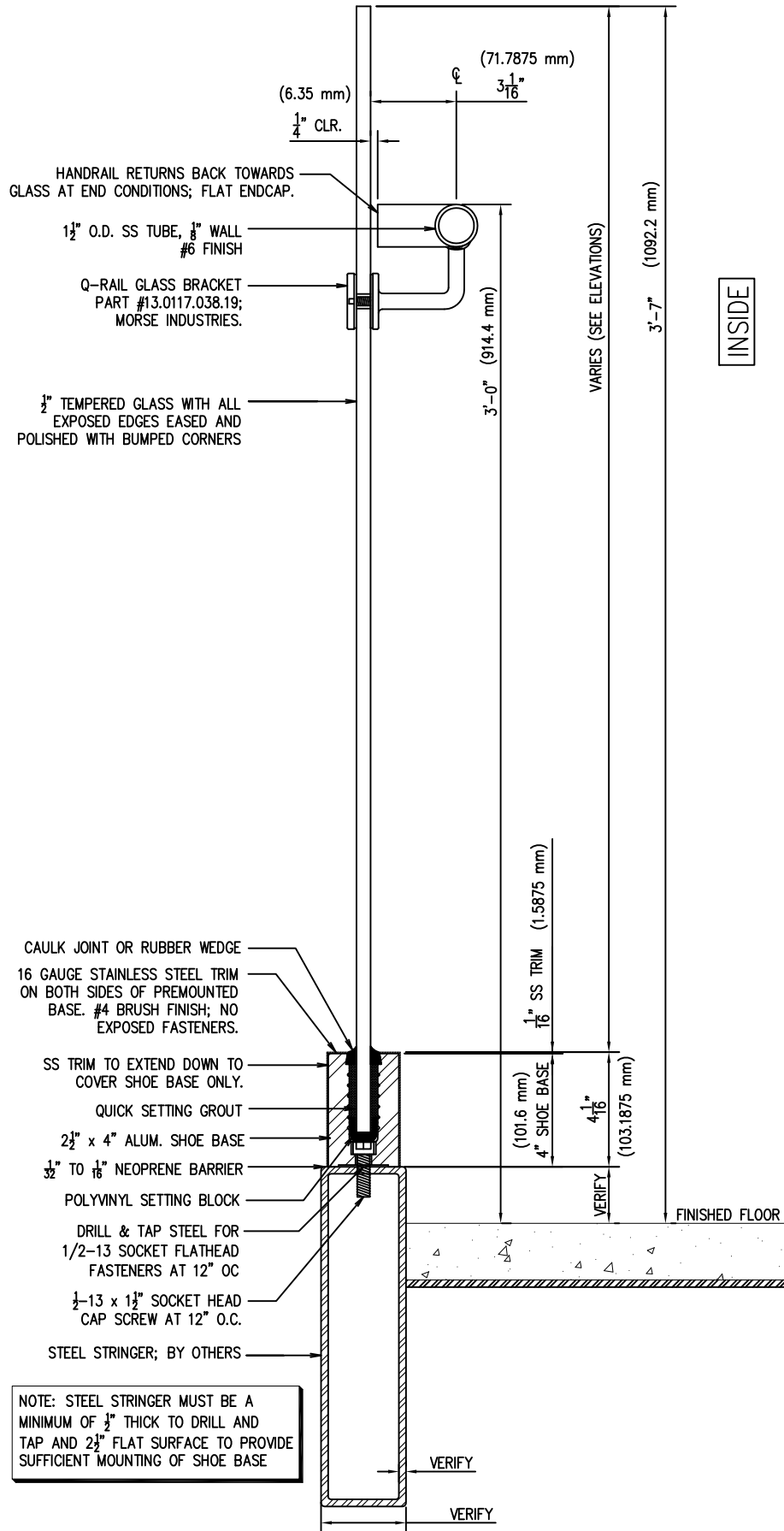

JOB # 862 LEVEL AND STAIR RAIL

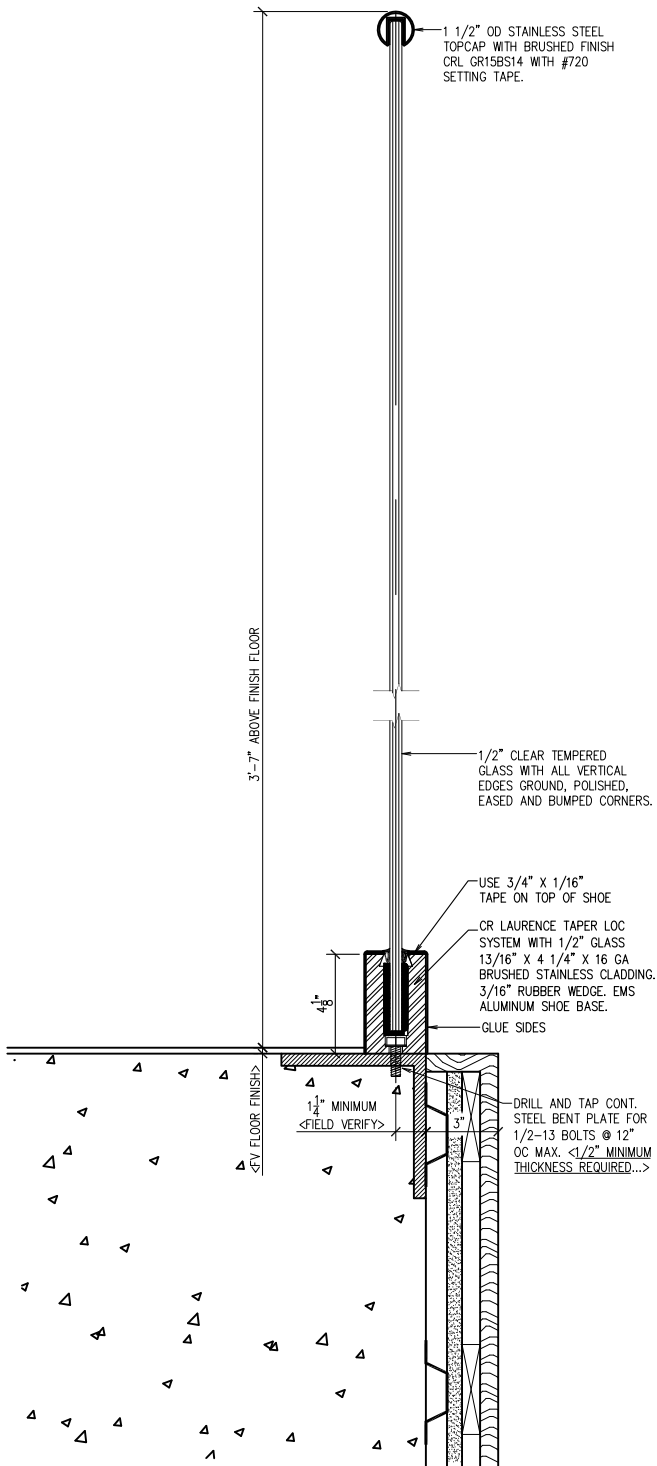

JOB # 873 LEVEL RAIL

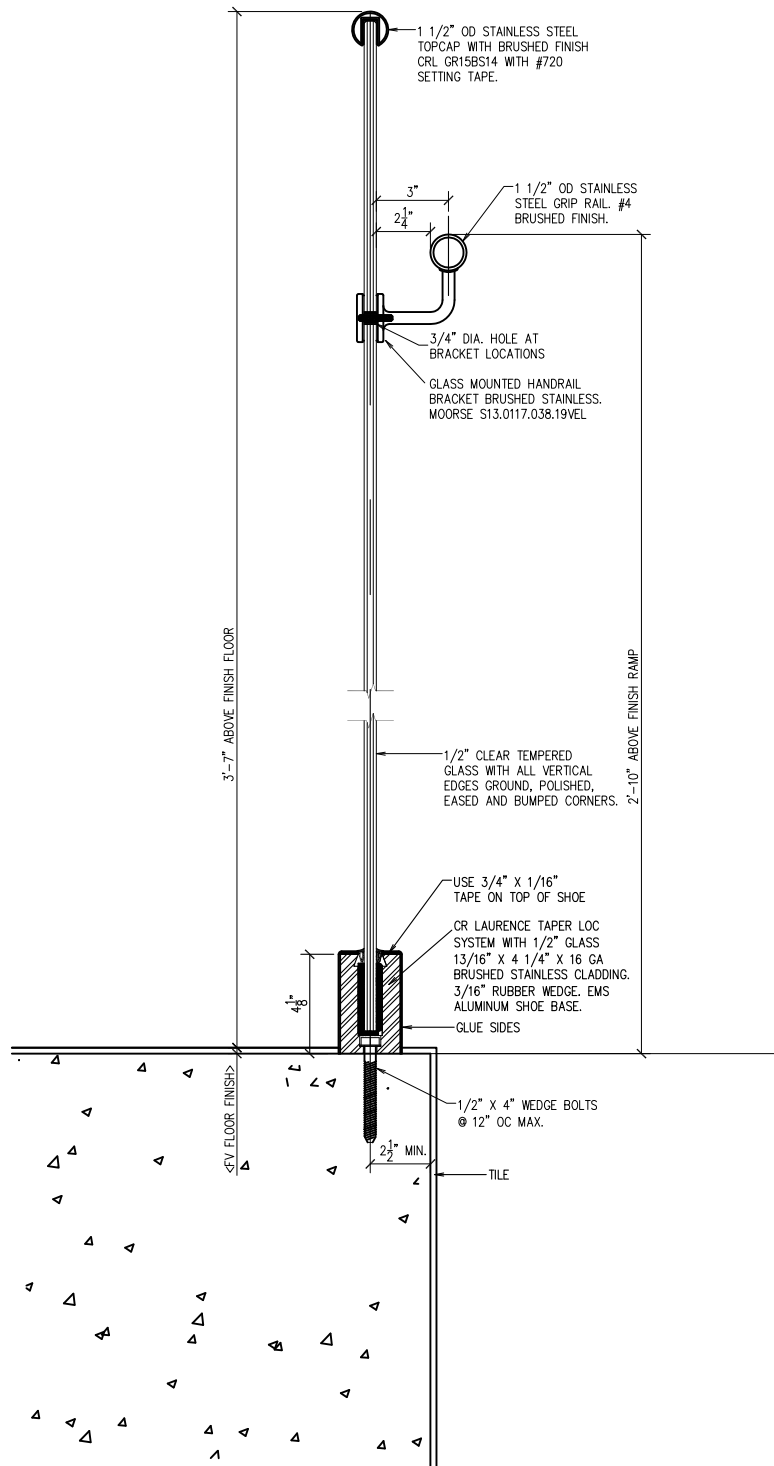

JOB # 873 RAMP RAIL

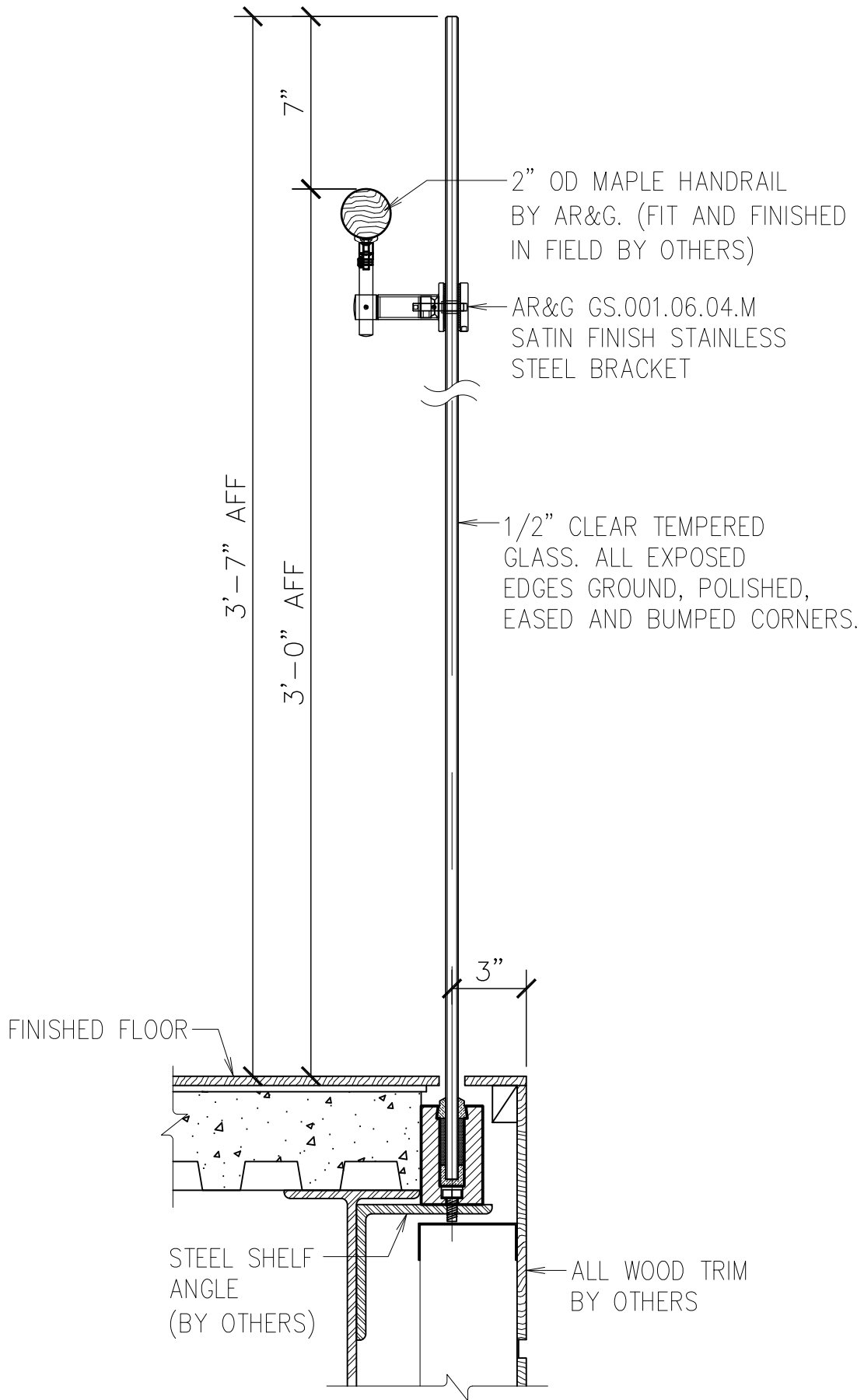

JOB # 894 LEVEL RAIL

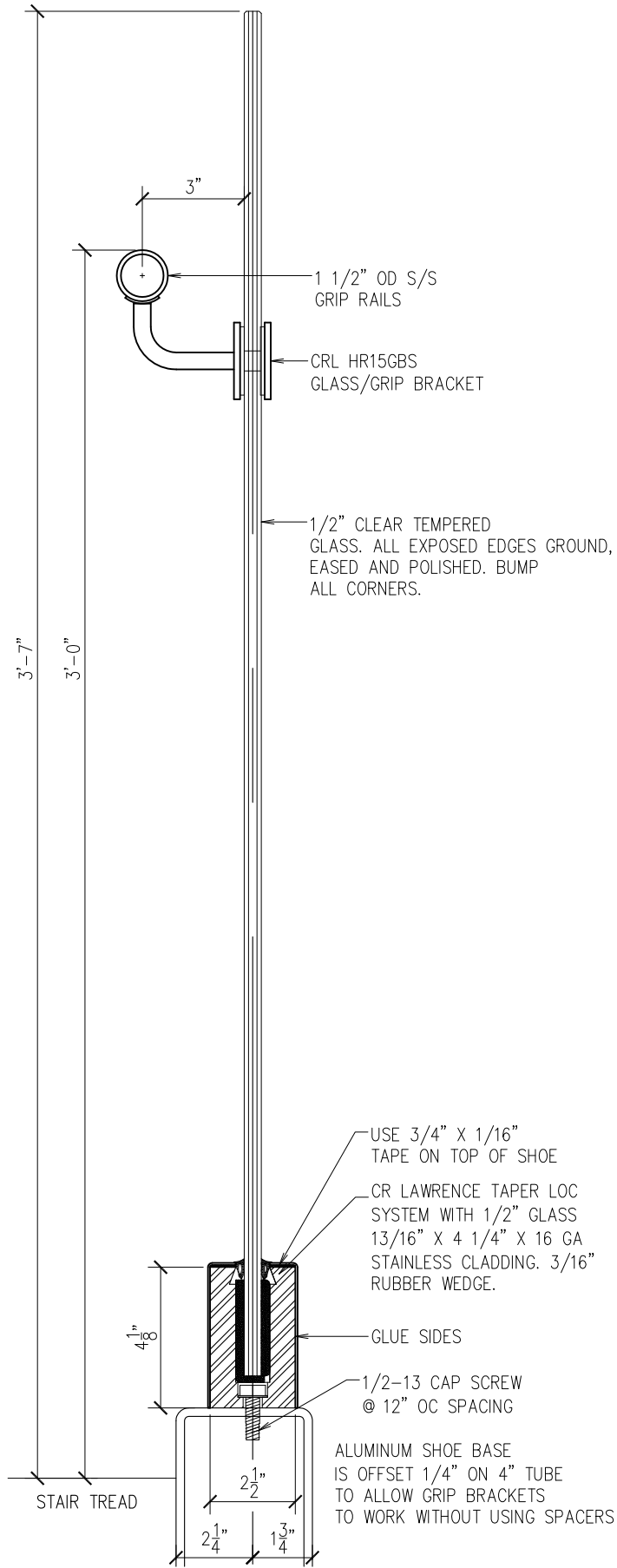

JOB # 901 LEVEL AND STAIR RAIL

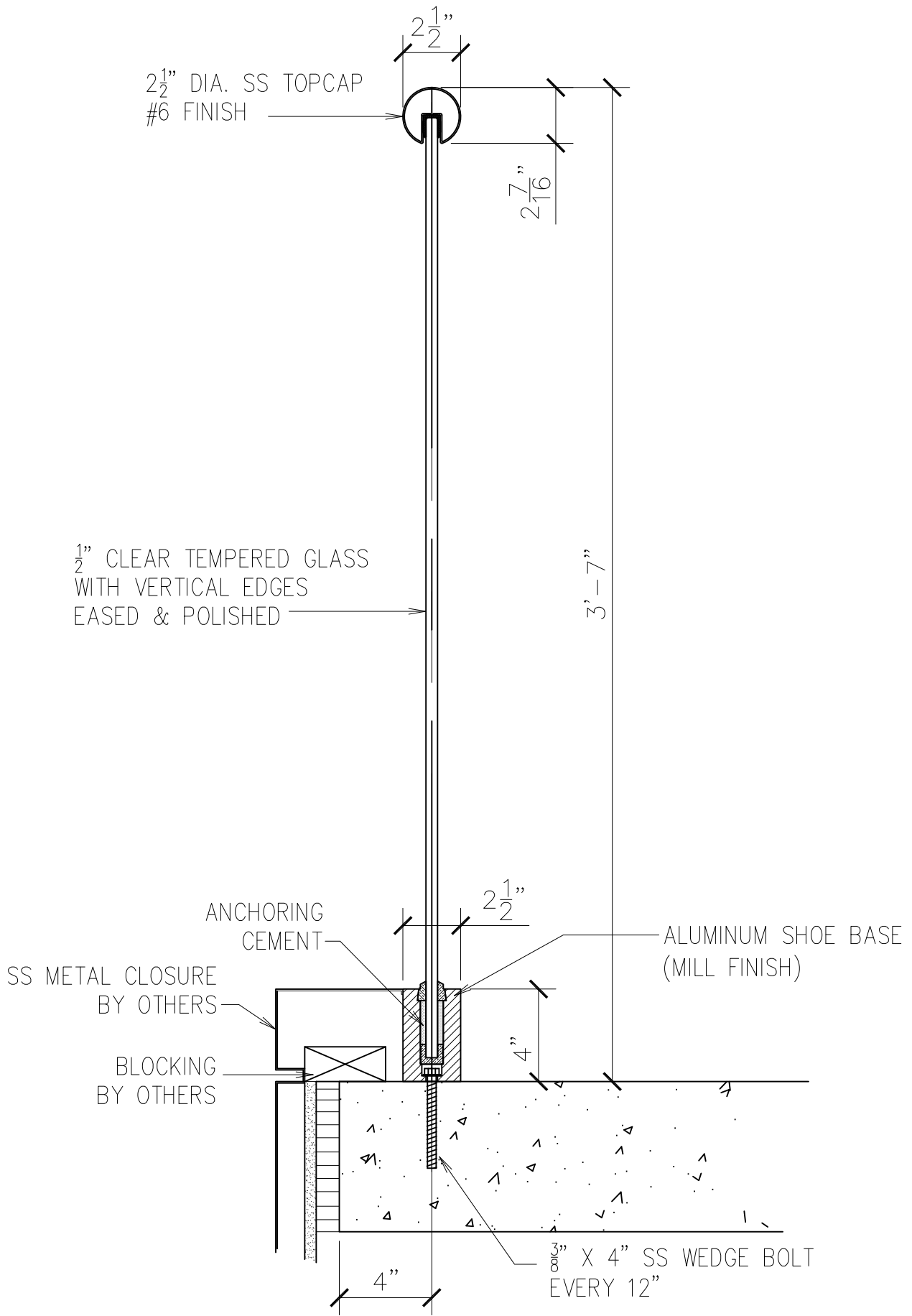

JOB # 907 LEVEL RAIL

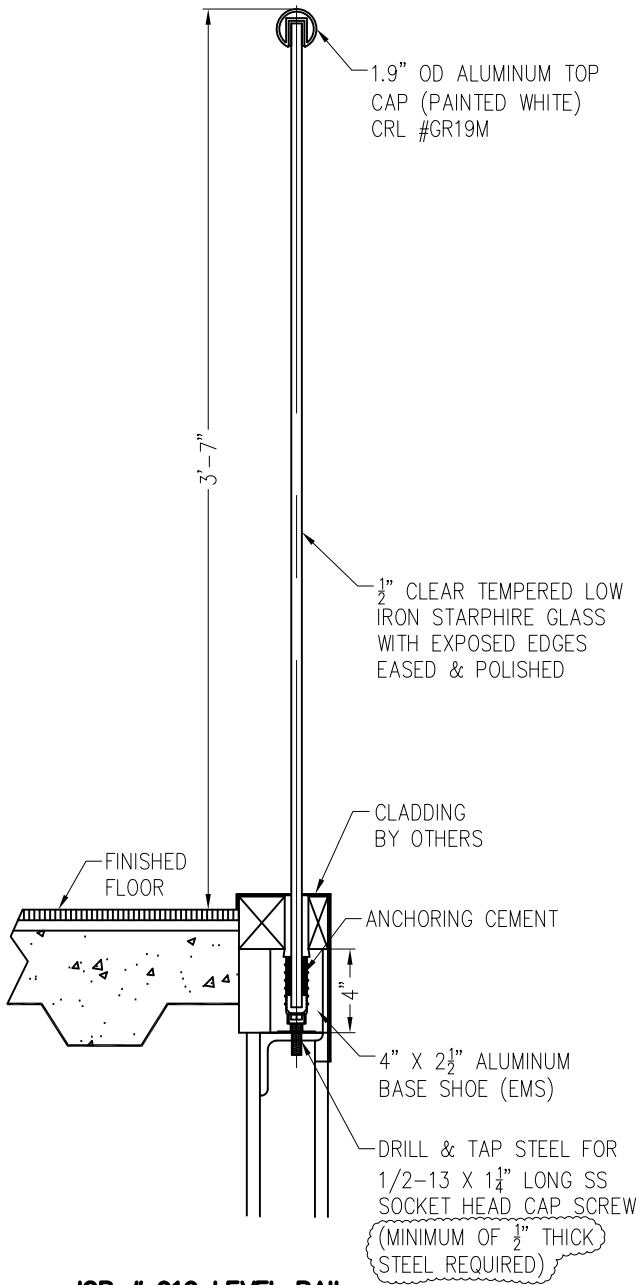

JOB # 919 LEVEL RAIL

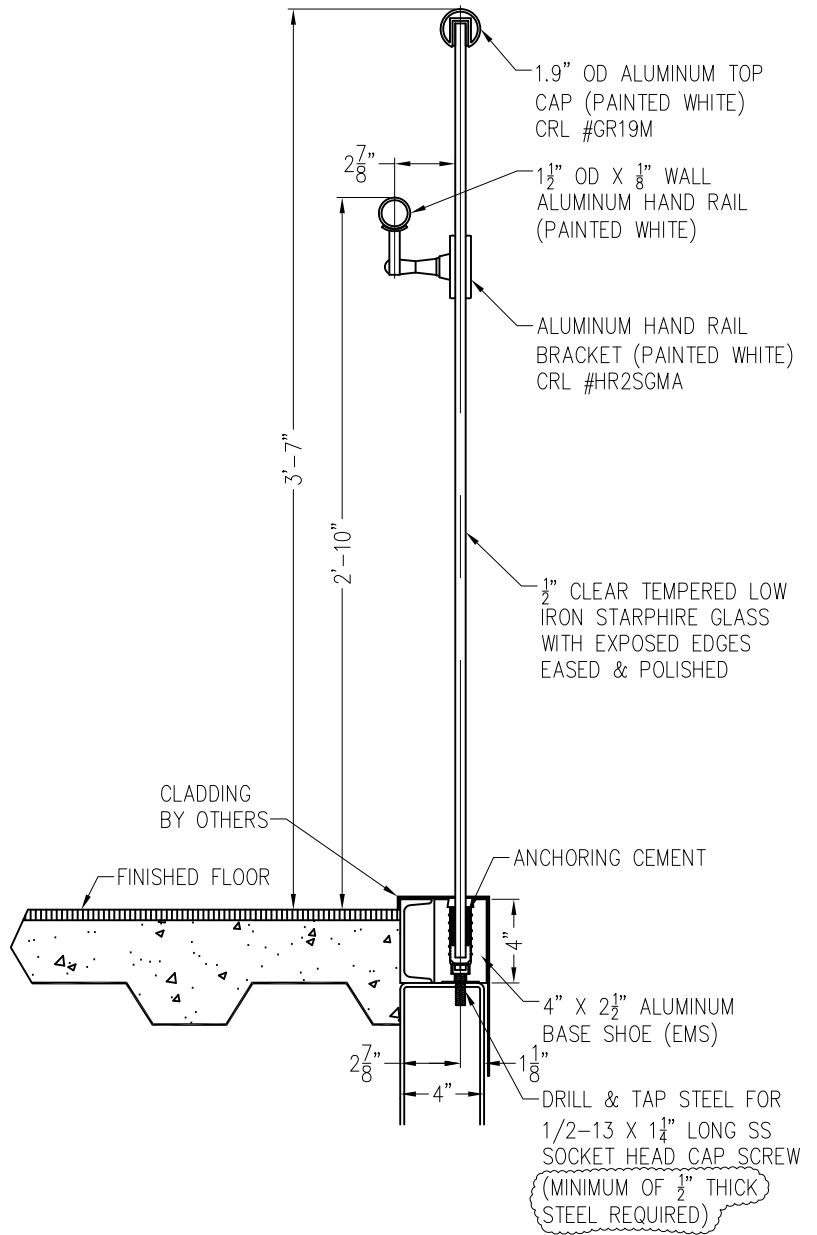

JOB # 919 STAIR RAIL